

Nourest[™]
STELLAR
4D Dual Roller Luxury AI Massage Chair

*Make your life healthy
and beautiful every day!*

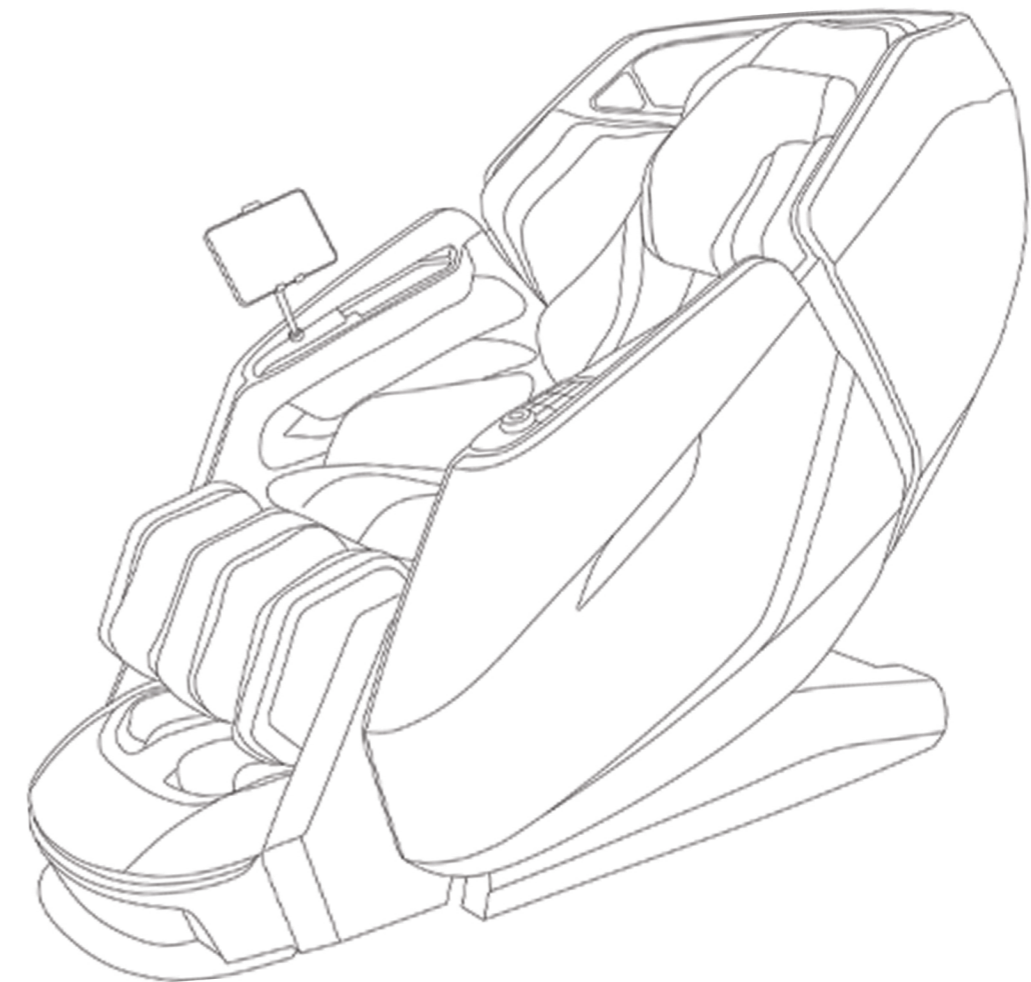

- ★ 1.Thank you for buying our massage chair
 - 2.Please read the user manual carefully to understand the operation way before operating the chair.
 - 3.Keep the user manual in a good condition for review if needed.
 - 4.Please pay special attention to “safety precautions” section.
- ★ Note: We reserve the rights of design change and explanation on the products, subject to change without prior notice, the pictures in the manual are for reference only, subject to real products.

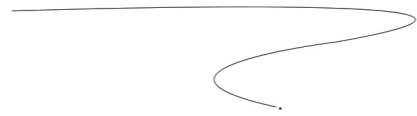

Contents

Preparation	Safety precautions -----	1
	External structure name -----	5
	Internal structure name -----	6
	Mechanical components diagram -----	7
	Mechanical components list -----	8
Installation	Installation -----	9
Massage Operation	The adjustment before massage -----	14
	Built-in remote instructions -----	16
	Tablet remote control operation -----	18
	Voice control use method -----	26
	After Massage -----	29
Maintenance	Clean and maintenance -----	30
Others	Malfunction guide -----	31
	Technical data -----	32





Please store the user manual in a good place for reading at any time

- ★ ● Please read this manual carefully before use, and install and use it correctly according to the requirements of the manual.
- ★ ● The safety precautions are to explain the size and severity of the hazard and damage. And divide some situations that may occur due to incorrect use and assumptions into two aspects: [Warning] and [Caution].



Both are important safety warnings, please pay attention to them.

 Warning	This symbol is a warning that death or injury may occur.
 Caution	This symbol is a warning of possible injury or damage.

The Meaning of Symbols

	This symbol indicates prohibited behavior.		This symbol means that it is forbidden to disassemble by yourself.
	This symbol means that you must follow the instructions.		This symbol indicates the correct operation of the power cord..

- ★ ● After reading the following content, please be sure to keep it at any time.

 Warning	
	<ul style="list-style-type: none"> ● Patients with osteoporosis, spine fractures, and those suffering from acute painful diseases such as sprains or muscle strains. ● Heart disease patients (including those who are equipped with a pacemaker or are using other medical electronic equipment) Malignant tumor patients. ● People who suffer from perceptual impairment due to diabetes and other high-level peripheral circulatory disorders. ● People with abnormal spine or curved spine. ● People with herniated disc. ● Pregnant women and those who have just finished childbirth, and those who are in poor health. ● People suffering from trauma such as thrombosis, acute venous tumor, various skin inflammations, etc. ● People who have been found to have lost the ability to discern temperature. ● People with high fever symptoms (acute inflammation: such as fatigue, chills, changes in blood pressure, physical weakness) ● Seniors over 80 ● People who are mentally handicapped, mentally handicapped, or incapable of operating this machine are prohibited from using this machine. ● People who cannot take care of themselves, infants and drunk persons are prohibited from using this machine. ● It is forbidden to use this machine if it gets wet or people with wet body. ● People who are not sensitive to heat or those who are allergic to heat must be careful when using it, or do not use it. ● Do not fall asleep in this chair. <p>People with the above symptoms are prohibited from using this machine, or must consult a physician before using this machine. If this product is used, close supervision must be carried out.</p>
	For users not suitable, it may cause accidents or physical discomfort.



Warning

	<ul style="list-style-type: none"> ● Before sitting, please make sure that there are no foreign objects between the various parts of the machine. ● When using the backrest lift, lower leg lift, and lower leg extension, make sure that there are no people or objects around (behind, under, or in front of the chair). ● If you experience abnormalities or feel abnormalities during use, stop using it immediately and ask your doctor. ● When massaging around the head, pay attention to the movement of the massage head, and don't massage the head too much. ● When massaging the surrounding areas of the neck, be especially careful and avoid massaging the neck too heavily. ● Do not use this machine to massage your abdomen or knees. ● If you want to leave the seat during the massage, you must stop the operation of the massage chair before leaving the seat. ● Do not use it with other equipment at the same time. ● Do not let children or pets play on or around the machine (especially when in use); also do not sit or stand on the backrest, armrests, or legs. ● When used by people with limited mobility or lack of communication skills, strict and continuous care must be provided. ● Before moving the machine, the angle of the backrest and legs must be adjusted back to the original state. 	Accident or injury
	<ul style="list-style-type: none"> ● When installing this machine, please turn off the power switch and unplug the power plug after the chair is reset. ● Only connect the plug of this machine to a suitable power outlet. And be sure to fully insert the plug into the power socket to reduce the risk of short circuit or fire. ● When not in use, be sure to unplug the power plug of the machine. Before unplugging the power plug, turn off all massage actions and switches. 	Fire and electric shock
	<ul style="list-style-type: none"> ● It is forbidden to curl and store the cushions and other accessories of the massage chair. ● It is forbidden to run the machine without load for a long time. ● It is forbidden to leave the appliance unattended after plugging in the power source. 	Accident
	<ul style="list-style-type: none"> ● Do not use it when the power plug or socket is loosely inserted. To prevent electric shock and short circuit. ● Do not use a power supply other than the rated voltage to avoid fire, electric shock or malfunction. ● The power cord must not be broken, reworked, twisted, stretched, knotted, or pressed with heavy objects (pay special attention not to be pressed under the machine), etc. ● If the power cord or plug is damaged, cannot work normally, please do not use this product. ● Keep the power cord away from heat sources. 	Fire and electric shock
	<ul style="list-style-type: none"> ● If the machine is not working properly, has been dropped or damaged, has been splashed or dropped into the water, it must be repaired by professionals or sent to the designated repair center. Do not modify, disassemble and repair by yourself. ● If the power cord is damaged, you must use a special power cord or buy special components from its manufacturer or maintenance department to replace it. ● To avoid electric shock or personal injury, please do not open or disassemble any parts of this machine without authorization. There are no user-serviceable parts in this machine. ● Before use, please lift the back cushion to check whether the fabric of the backrest and other parts is damaged. If there is any damage (no matter how small the damage), please stop using it in time and unplug the power socket. Request for a repair. 	Disassembly and repair



Caution

	<ul style="list-style-type: none"> ● This product is intended for use by individuals weighing below 120 kilograms. 	When used by overweight individuals, the product may generate significant noise during operation, and the fabric may wear out more quickly."	
	<ul style="list-style-type: none"> ● Please use it on a flat ground. 	To prevent it from accidental dumping.	
	<ul style="list-style-type: none"> ● Please start with a light massage. The recommended use time is 20 minutes, and the same position massage within 5 minutes. 	Long time continuous use will have an adverse effect.	
	<ul style="list-style-type: none"> ● Please confirm the correct position of the massage head before sitting down slowly. 	To avoid accidental damage.	
	<ul style="list-style-type: none"> ● The tablet hand controller should be placed on the tablet support in time, and do not randomly place it to avoid damage to the tablet hand controller from being squeezed or dropped. 		
	<ul style="list-style-type: none"> ● Before connecting the power plug to the socket, be sure to check that the power switch is in the off position. 	Otherwise, it may cause an accident when the power is restored.	
	<ul style="list-style-type: none"> ● When not in use, before unplugging the power plug, turn off all massage actions and switches. 	To reduce the risk of short circuit and fire.	
	<ul style="list-style-type: none"> ● Be sure to insert the power plug completely into the power socket. 	If you don't pay attention, you may get an electric shock in case of leakage or malfunction.	
	<ul style="list-style-type: none"> ● Check whether the power cord is damaged, there should be no adherents such as moisture or trash on the power plug. 		
	<ul style="list-style-type: none"> ● For safety, please install the ground wire accurately. The power plug must be plugged into a socket with a grounding wire. The ground plug cannot be bent or removed. 		
	<ul style="list-style-type: none"> ● Do not press or step on the massage head with hands and feet. ● Do not reach between the active massage heads. ● Do not put your hands and feet into the gaps of the movable mechanism. ● Please do not let objects fall or jam into any slots of the machine. ● Do not stand, sit or put anything on the backrest, armrests, or calves. ● Do not stand, sit or put anything on the backrest, armrests, or calves. ● Do not stand on the machine during use. ● Do not unplug the power plug and turn off the power switch during use. ● Do not put your hands and head into or under the calf massage area. ● Do not use hard hair accessories on the head. ● When massaging the buttocks and thighs, there should be no hard objects in the trouser pockets. ● Do not hit the armrest with hard objects or sharp cones, so as not to affect the appearance of the armrest. ● When the backrest of the massage chair is in an inclined position, do not sit on it or press it heavily. ● Do not use it when the skin is bare or wearing only thin clothes. Although thin clothes can enhance the massage effect, it may cause skin irritation and pain or low-temperature burns. ● Do not use this product immediately after meals, as it may cause physical discomfort. ● Do not use this machine while wearing loose clothes or jewelry. ● Keep long hair away from the massager. 	Keep long hair away from the massager.	
	<ul style="list-style-type: none"> ● Keep this machine away from heat, humidity, sharp objects, and corrosive, flammable and explosive environments. ● It is forbidden to put heating items such as electric blankets on the machine. 	Otherwise, the fabric will fade, change color, or harden and deteriorate the synthetic leather.	
	<ul style="list-style-type: none"> ● Do not approach the stove or place it around heating appliances such as heaters. 		
	<ul style="list-style-type: none"> ● Do not place it under direct sunlight or in an environment where the room temperature is higher than 40°C. 		
	<ul style="list-style-type: none"> ● Do not place it in an environment with severe dust or corrosive gas. 		
	<ul style="list-style-type: none"> ● Do not place it in a small space or use in a place with poor air circulation. 		
	<ul style="list-style-type: none"> ● Do not use this unit outdoors. 		



Caution

	<ul style="list-style-type: none"> Please keep it dry and do not use or store this product in swimming pools, bathrooms and other particularly humid environments. The chair and the controller can not be sprinkled with water. Do not use this product when the body is wet. 	To prevent leakage or electric shock.
	<ul style="list-style-type: none"> Be sure to install the ground wire correctly. (Improper grounding connection may cause electric shock hazard. If you have any doubts about the correctness of the grounding of the machine, please entrust a qualified electrician for inspection.) Please do not use plug adapters. (If the plug attached to the machine does not match your socket, please do not modify the plug, but ask an electrician to install a suitable socket.) 	To reduce the risk of electric shock.
	<ul style="list-style-type: none"> Before cleaning the machine, be sure to unplug the power plug. After using this machine, be sure to unplug the power plug. 	To prevent fire or electric shock.
	<ul style="list-style-type: none"> In the event of a power failure, please unplug it immediately. Please pull out the power plug by holding the plug. Avoid pulling the power cord to unplug the power plug. 	
	<ul style="list-style-type: none"> After each massage, please turn off the power switch and unplug the power plug. Unplug the plug immediately when there is a power failure. 	<p>To prevent accidents.</p> <p>Otherwise, it may cause an accident or injury when the power is restored.</p>

Usage environment	Environment temperature : 0°C~35°C Relative humidity : 20%~80%
Storage environment	Environment temperature : -5°C~35°C Relative humidity : 20%~80%

★ Grounding Instructions

※This machine is equipped with a cable with a grounding plug. The plug must be plugged into a well-installed and grounded socket that meets the requirements of this plug.

★ Replace the Fuse

★ ※When the fuse is blown, please unplug the power plug first, turn off the power switch, then use a screwdriver to open the fuse box cover on the switch box, replace with a new fuse of the same specification, and then reinstall the fuse box cover or entrust an electrician to assist in the replacement.

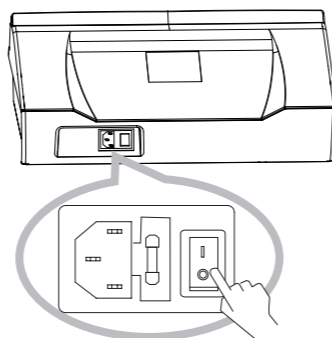

The place where the ground wire cannot be set.

Gas pipe: may cause explosion and fire.
Telephone lines and lightning rods: lightning may cause electric shock and fire.
Water pipe: The ground wire does not work where there is plastic in the water pipe.

External Structure

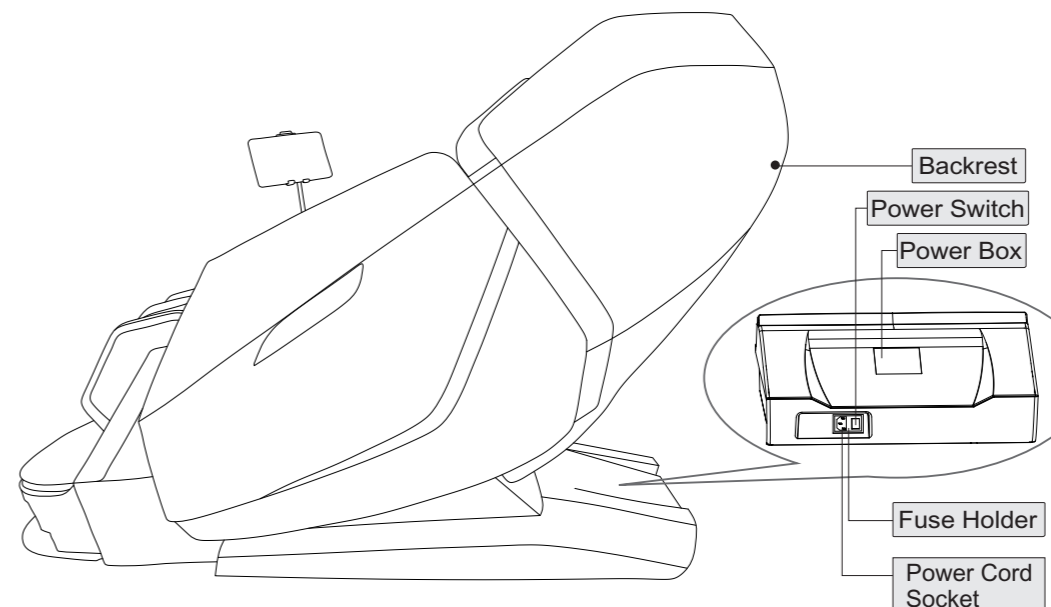
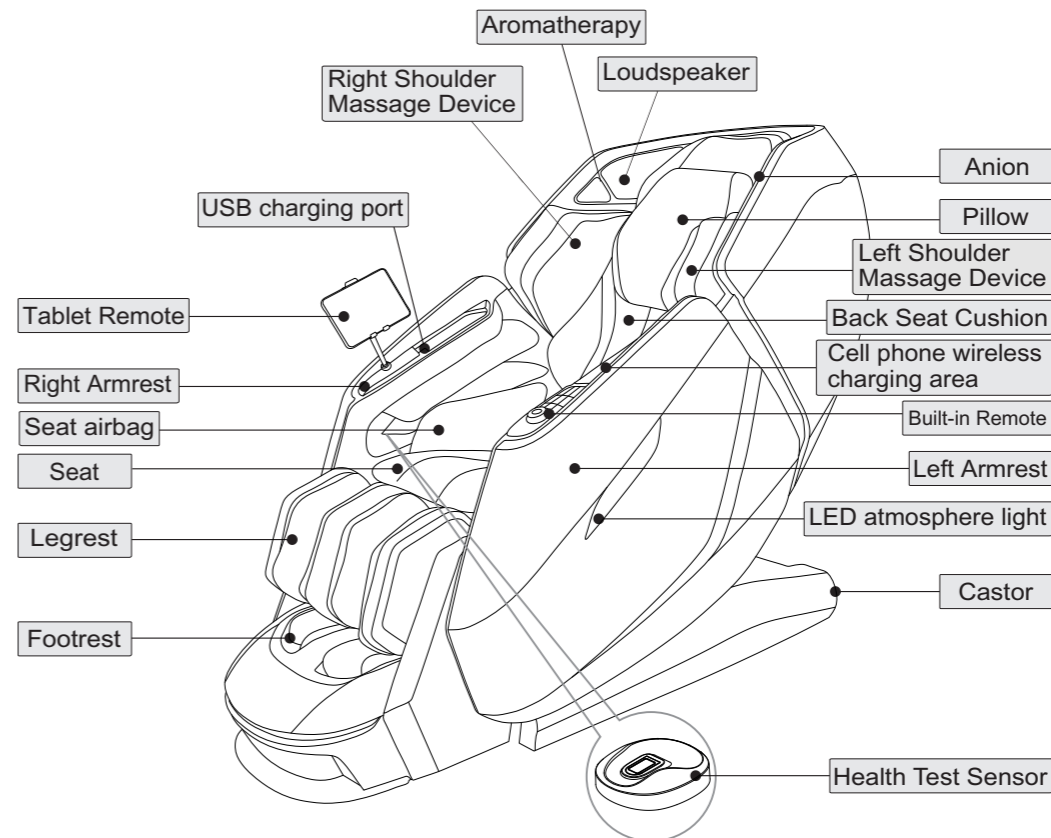

Internal Structure

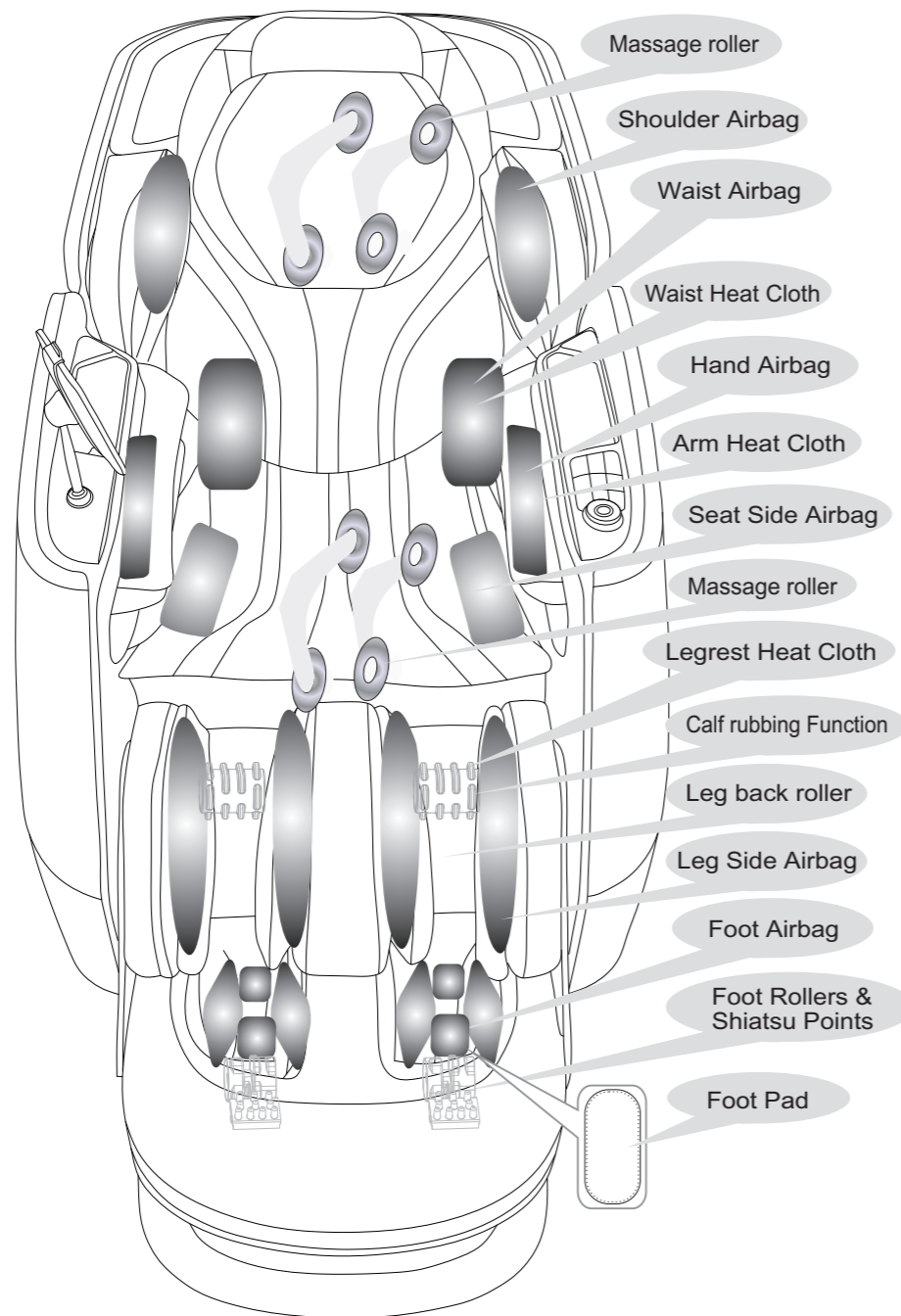

Preparation

Mechanical Explosive View

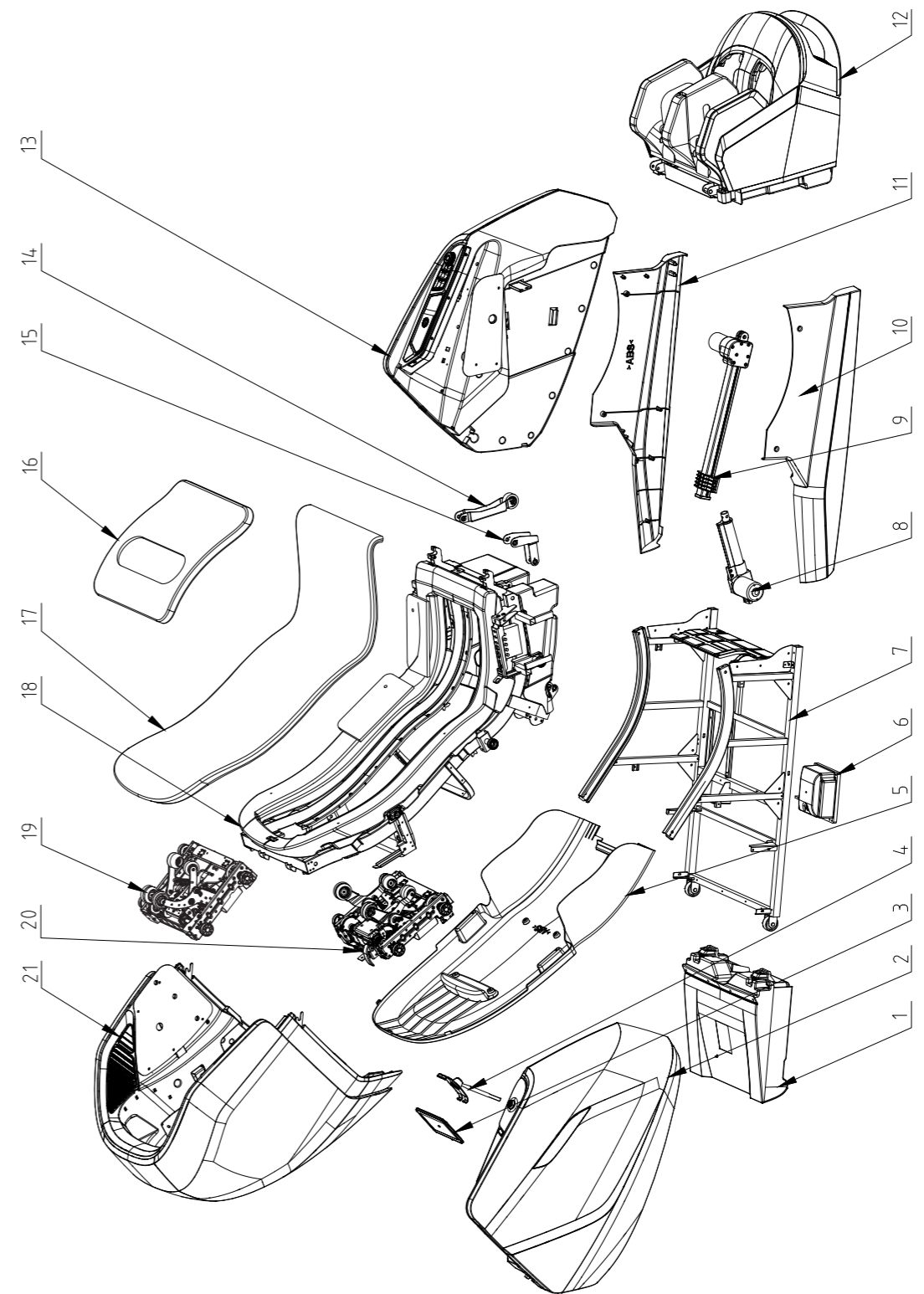

Preparation

Mechanical Components List

NO	NAME	PIECE	NO	NAME	PIECE
1	Power Box Assy	1			
2	Right Armrest Assy	1			
3	Tablet Remote	1			
4	Tablet Bracket Assy	1			
5	Backrest Cover	1			
6	Air Pump	1			
7	Seat Frame Welding Assy	1			
8	Electric Actuator	1			
9	Seat Actuator	1			
10	Right Fender	1			
11	Left Fender	1			
12	Leg-rest Assy	1			
13	Left armrest assembly	1			
14	Legrest Actuator	1			
15	Actuator Split Ear Seat Component	1			
16	Shoulder cushion	1			
17	Back Seat Cushion	1			
18	Back-rest Assy	1			
19	Upper Mech	1			
20	Lower Mech	1			
21	Shoulder Assy	1			

Installation 1

- **Decide the setting place.**

- Please make sure you can tilt the space.

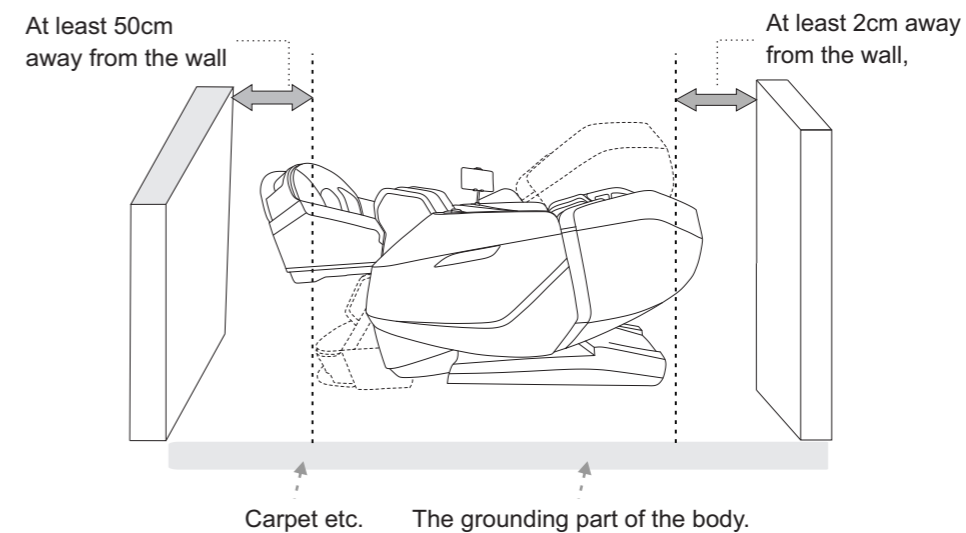
**Hint:**

because sometimes can damage the floor, so it is recommended to put carpet etc under the body. When laying, prepare a rug that can cover the ground part of the body.

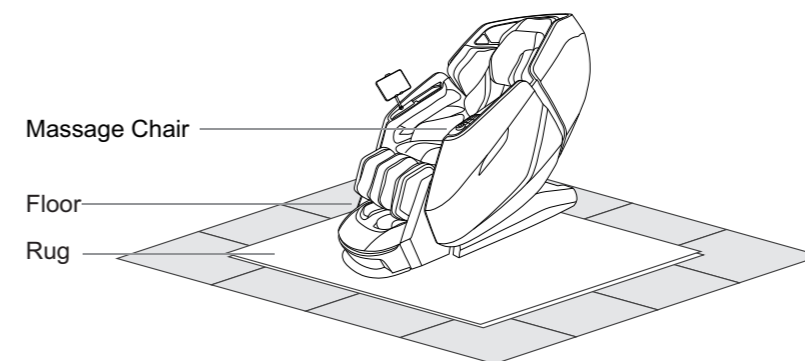
**Attention:**

- Do not use or store the product in swimming pool, bathroom or other particularly humid environment.
 - To prevent leakage, electric shock or failure.
- Please use on a flat field.
 - Prevent accidental dumping of the machine.
- Do not close to the stove or placed around the heating fan and other heating appliances.
 - Can cause fabric fading, discoloration or synthetic leather hardening deterioration, etc.

Installation 2

Step 1 Take footrest, main body and accessories from the packing box

① Hold the left and right sides of the legs and footrest with both hands and lift the legs and footrest out of the seat of the main body

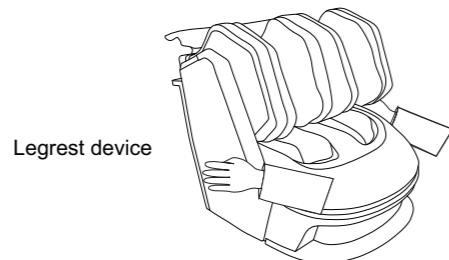

Legrest device

② Take out the accessories box and other parts, and lift out the body of the massage chair by more than two people.

③ Check and confirm whether the attachments are complete (please check one by one against the packing list)

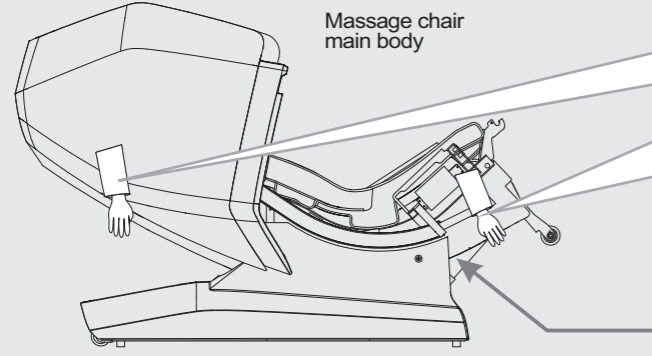

Massage chair main body

One person holds the handle of the backrest with both hands, and the other person holds both sides of the lower backrest with both hands and slowly lift it out.

Note: It is forbidden to move this location

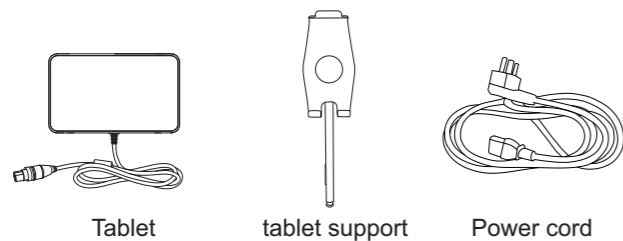

Tablet

tablet support

Power cord

③ lift out the left and right armrest put the armrest flat on the table or the ground. (Be careful not to scratch).

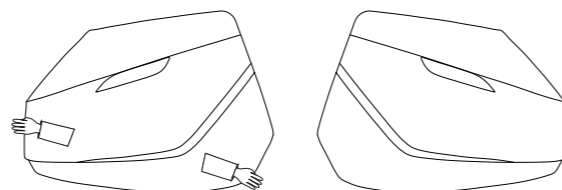

Left armrest

Right armrest

Installation 3

Step 2 Reset the massage chair

① Insert one end of the cable into the power box jack, the other end insert to the power socket, turn on the switch on the power box, the massage chair is in powered status. ② Insert the concave position of the remote plug to the remote cable socket convex position of the left of the seat, insert tightly then twist the nut tightly. ③ Turn on the on/off button of the tablet remote, then turn off, now the backrest is upping and the seat is downing. Put the remote on the seat temporarily after the backrest is reset. ④ After the backrest is reset, please turn off the switch and unplug the power.

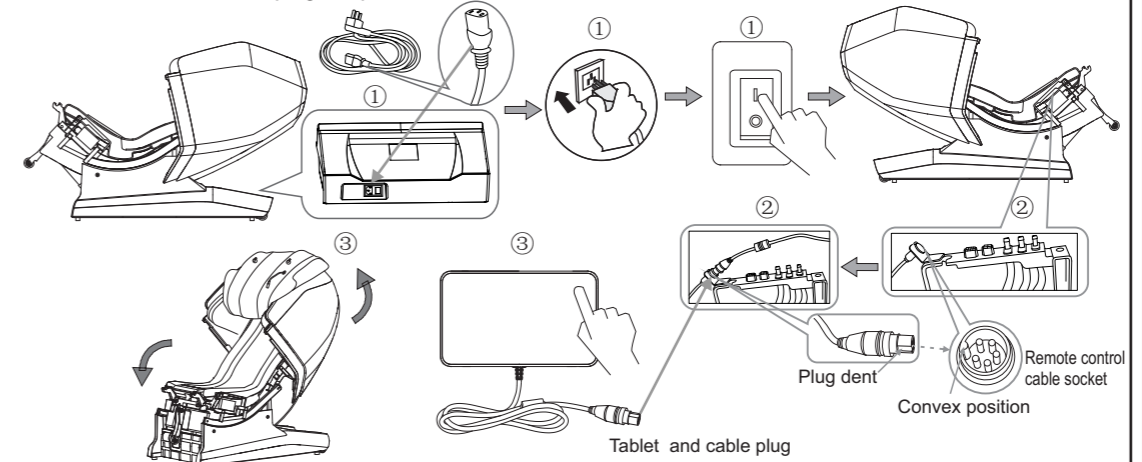

Tablet and cable plug

Plug dent
Remote control cable socket
Convex position

Step 3 Install left and right armrest

① Twist down the four M6*20 screws on the front end of the iron frame on both sides of the seat. ② Put the right armrest close to the side of the main machine, insert the side wire harness of the chair shoulder to the wire harness socket of the chair shoulder side. ③ Insert the shaft of the rear armrest into the slot plate of the side top part of shoulder. ④ Clip the connector under the armrest into the slot plate on the side of seat frame. ⑤ Insert firmly the air tube of the armrest to the seat air tap, and insert firmly the wire harness. ⑥ Aim the fixed panel on the side of the armrest to the fixed shelf hole on the side of the seat frame, then twist two M6*20 screw+big gasket with Phillips screwdriver and twist firmly. ⑦ Install the left armrest follow the above steps, there is no wire harness on the left armrest.

Note: Do not squeeze the air tube during installation, otherwise it will lead to air leakage or the air bag will not inflate. Make sure the connection of the fixing plate and wiring harness is firm, otherwise the armrest will fall off or the convenient hand controller, speaker and Bluetooth will not work

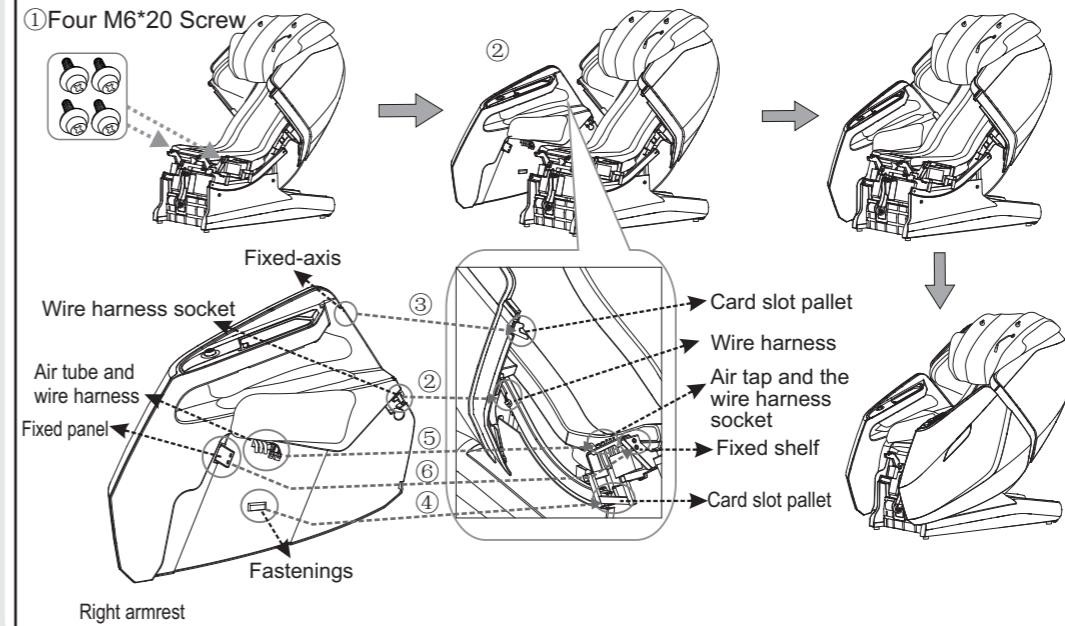

① Four M6*20 Screw

Fixed-axis

Wire harness socket

Air tube and wire harness

Fixed panel

Right armrest

Fastenings

Card slot pallet

Wire harness

Air tap and the wire harness socket

Fixed shelf

Card slot pallet

Installation 4

Step 4 Install the legs and footrest.

①Screw down the legs and footrest hanging ears;②Plug the wire harness into the socket;③ Connect the air tube of leg-rest with the air nozzle of the main machine firmly; ④Lift the upper rotating shaft press plate of the hanging ear, lift the legs and footrest, put the rotating shaft into the main engine hanging ear, and put the rotating shaft press plate down; ⑤Tighten the screw;

⚠ Note: When connecting the air pipe and the wire harness, the air pipe and the wire harness should not be wound together.

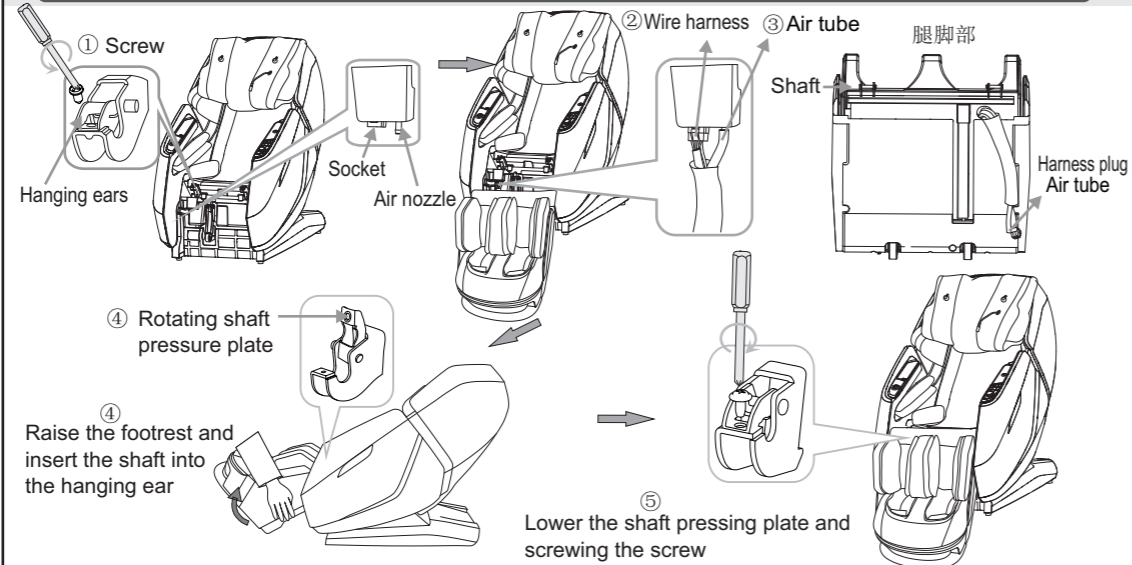

Step 5 Install the bracket of the tablet hand controller

①Insert the plate bracket rod into the bracket seat of the right armrest. Insert it according to the shape of the bracket and the shape of the seat hole until the bottom screw of the bracket is stuck in place; ②Put the tablet controller into the bracket;

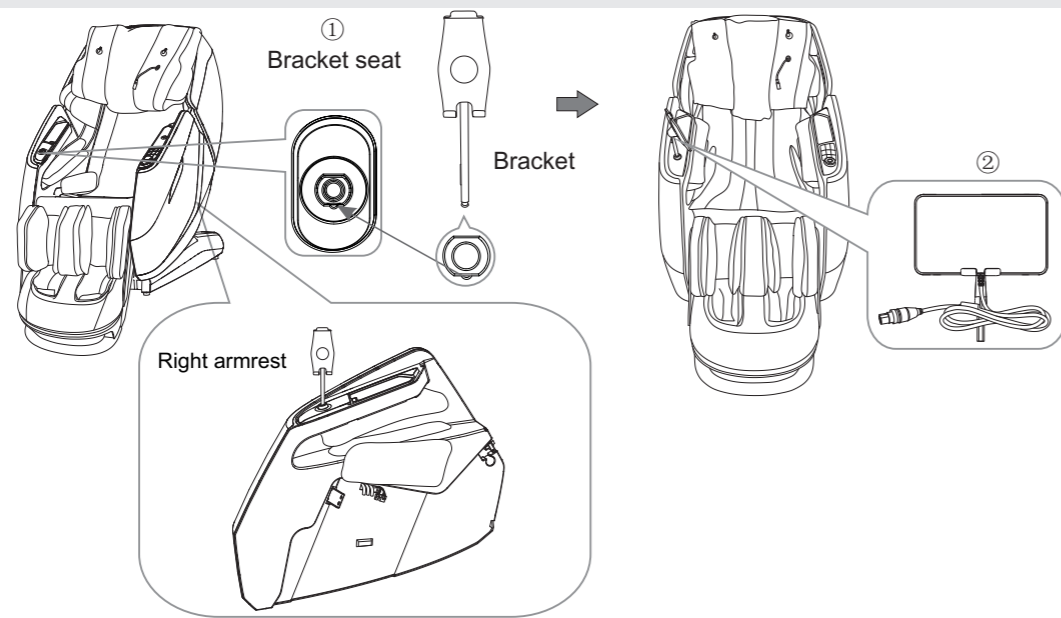

Installation 5

Step 6 Connect the air pipe with the heating wire and install the back seat cushion

Connect the seat part and the air tube of the waist airbag; connect the waist heating wire; finally connect the back cushion zipper together.

★ Warm Suggestion

When the people sits on the chair, the bottom of the pillow is level with the ear, and then the pillow is connected with the back . In this way body detection will be more accurate, to achieve a comfortable massage effect.

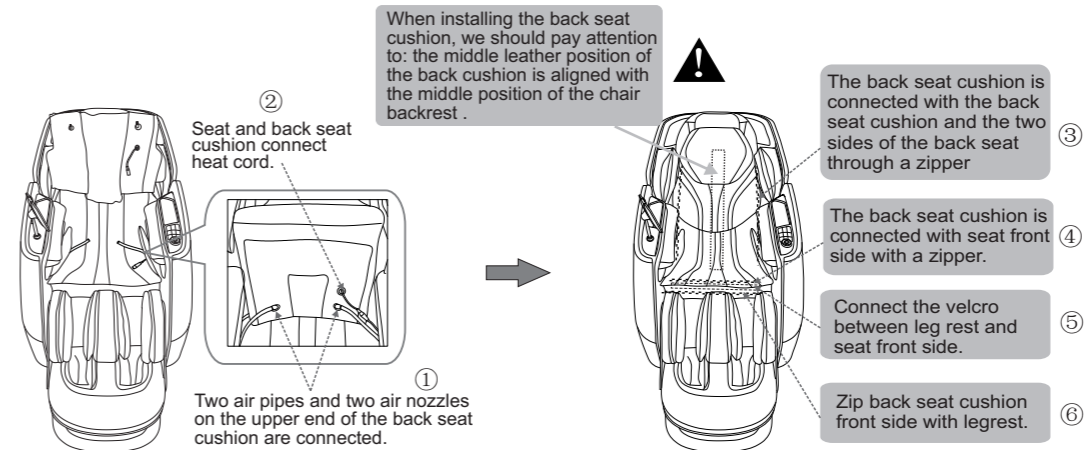

Step 7 Operation after installation

- 1 Plug the power plug into the power box socket under the backrest(Picture) :
- 2 Insert the other end of power plug from the power cord into the power socket.
- 3 Turn on the power switch at the back of the power box.
(Power switch "O/I", press I to connect.)
- 4 Use the fast access buttons on the armrest or the tablet hand controller to choose the massage function, enjoy this product to bring you relaxed and comfortable massage.
- 5 Choose the aromatherapy tablet according to personal preference.

⚠ Before connecting the power plug to the socket, be sure to check that the power switch is in the off position.

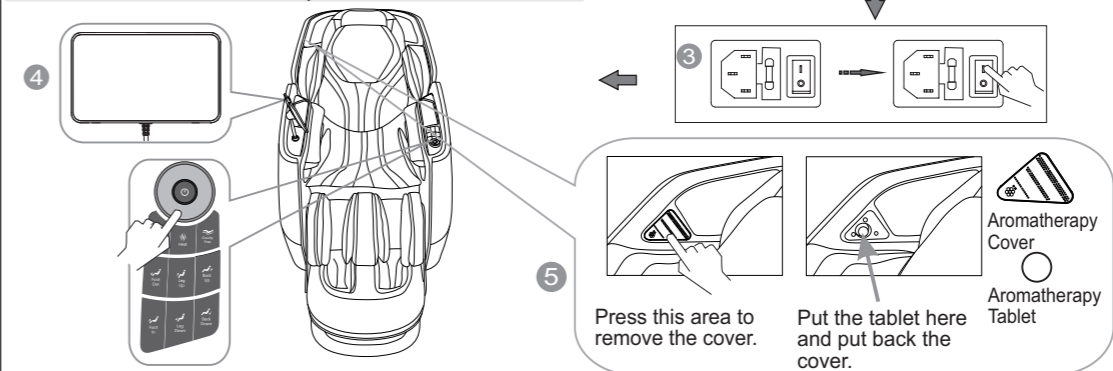

Environment



Caution



Don't use the chair in wet places like near swimming pool, bath room to avoid leakage or electric shock.



Don't use under sunlight or near stove or other heating place to avoid upholstery deteriorated.



Please use chair in flat place to avoid chair falling or noise or other unexpected trouble.

● Check places in front

Check the areas when back and leg extending, make sure no people, pets or other things around.

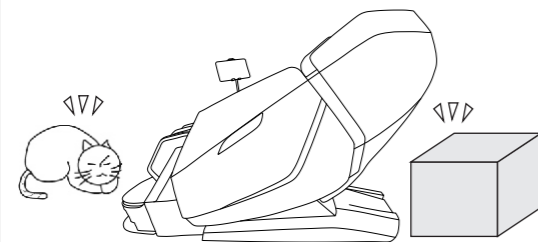

● Check power cable, plug

(1) Clean the dust on plug on time. (using dry cloth).

(2) No damage, re-do, bend, stretch, tie or press with heavy thing (especially can't be pressed by the chair) on power cable.

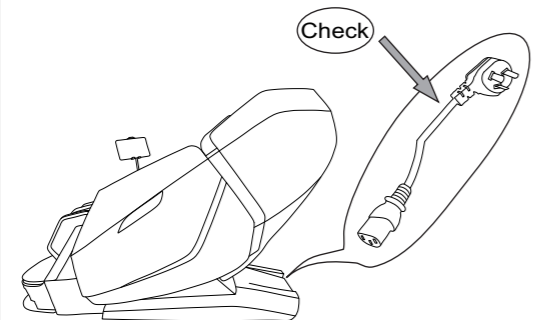

Check environment

● Space size for using the chair

- Zero space from wall.
Tips: at least 2cm from wall.

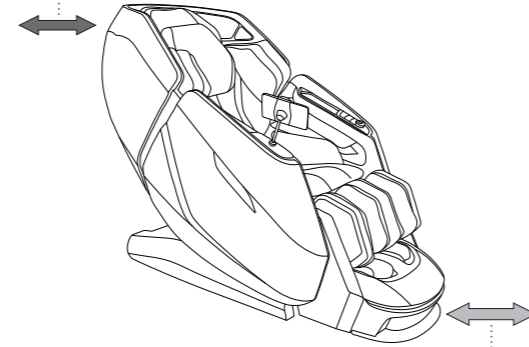

- At least 50cm in front of the leg.

● Check surroundings

When the backrest or legrest reclines or extends, please pay attention to:

- (1) Check any person or things in every direction.
- (2) Check the space size.

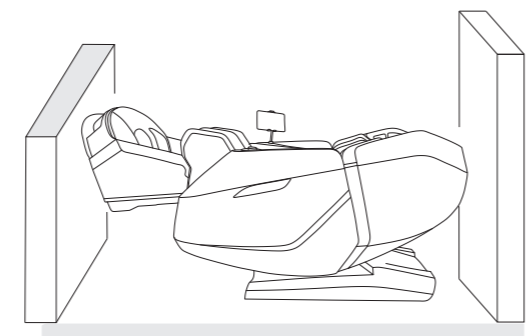
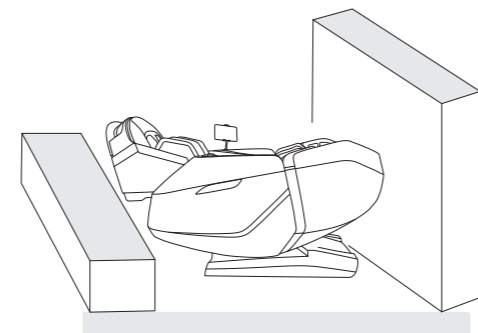

How to move massage chair



Caution

- ✦ Don't move chair when it's working in case of accidents or damage

How to move

- ✦ Bind the cables and put them in the seat to avoid damage when moving.
- ✦ If you plump the chair, it may damage the inner parts of the chair.
- ✦ Don't use the castor if the floor is wooden or other easy damaged material. It will need 2 or more persons to lift the chair.
- ✦ Make sure the power is off and the plug doesn't touch the floor (It's better to let the chair in standing status to avoid the back crashing the floor)



Normally

- 1 Press down the head part to make the gravity fall on the back castors. Then push the chair to desired destination steadily and set it down slowly.

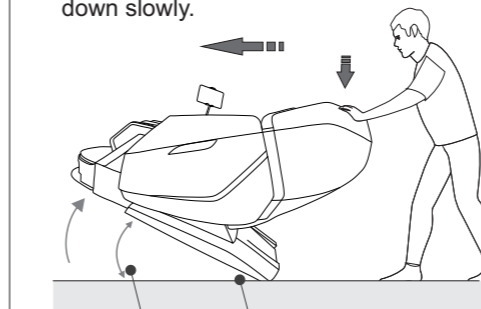

- ⚠ Please hold the footrest to move the chair as shown in the picture in case any scratches on the leatherette. During massage chair backrest lie down process, can't move the armrest.

● Kind suggestion

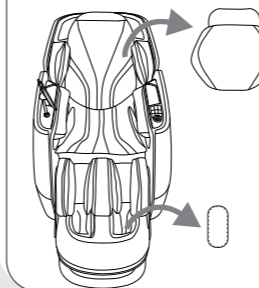

- If you think the back massage is not strong enough, please remove the pillow before massage.
- If you think the foot roller massage is weak, please remove the foot pad.

Adjustment before massage

● Before adjustment

- ✦ Please confirm the massage mechanism is at the right position before sitting in the chair.

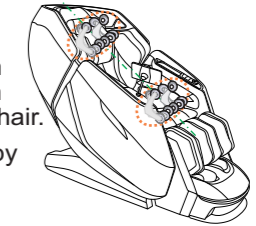

- ✦ Avoid injury caused by improper position of massage head.

✦ Shoulder Height Detection

During the shoulder height detection, if the massage mechanism can't find the shoulder, the default position is the middle back area.

Proper posture: please put your back against the back of the chair and lean your head back on the pillow cushion.



● Foot Safety Anti-Clip Function

When the footrest angle is being adjusted, the massage chair can automatically detect the length of human legs, do not put your feet on the out cover if footrest now, otherwise it will affect the detection of the leg length, resulting in retraction failure of the footrest. Also, there is anti-pinch reminding on auto program interface of tablet controller.

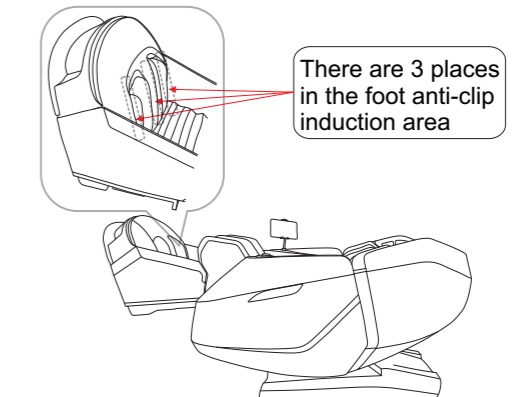

When the massage chair is turned off, do not put your feet or any parts on footrest, or the foot retracts will stop; In this state the chair continues reset, the legs and feet can not be collected to the original position.

Note: When the power is turned on, the massage chair should be fully reset. Turn on the machine again, otherwise it will cause the anti-clamping function to fail.

The power box have the flowing anti-pinch function, if there is heavy obstacle pressed the cover of power box, the backrest will stop declining, and continue to decline after heavy obstacle removed.

Built-in Remote Instructions

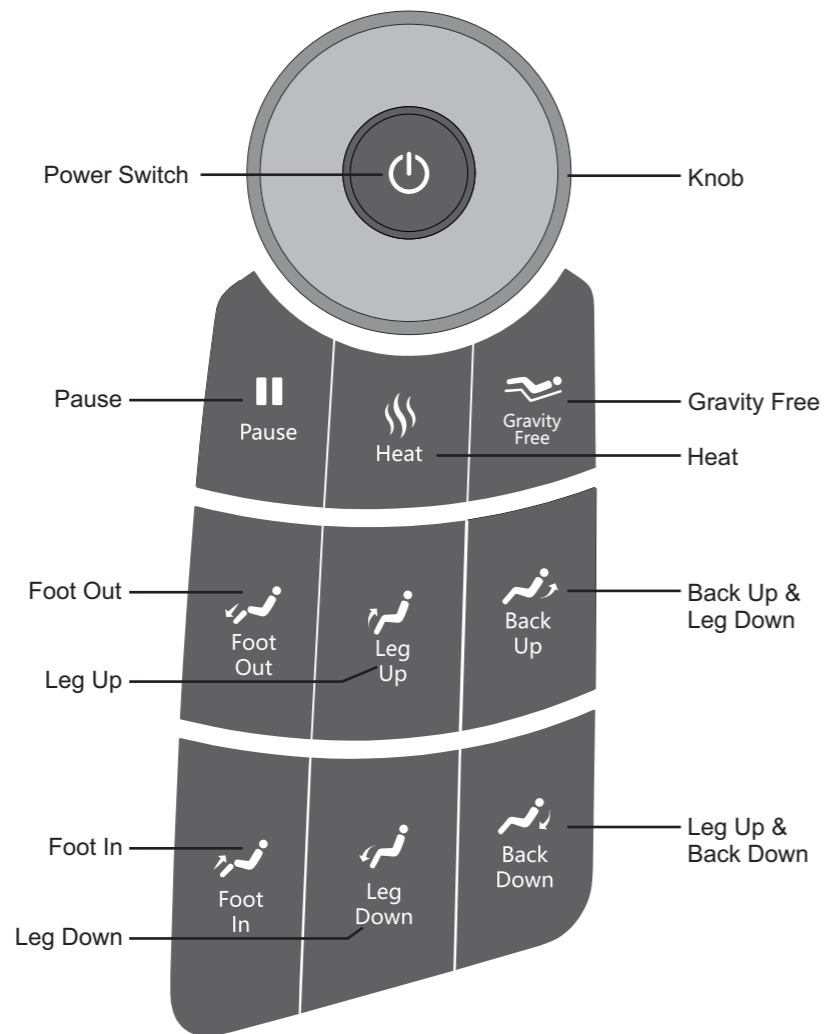

Massage operation

Tips: When the following functions are enabled, the tablet hand controller will display the status synchronously.



1. In STANDBY status, press this key for 2s, massage chair will power on; in ON status, press it for 2s to turn off the chair and reset. In ON status,press it to enter Auto programs.



2. Knob, clockwise rotation can control the 4D+, counterclockwise rotation can control the 4D- .



3. In ON status, press this key to enter Pause mode, back light becomes red, press it again to restart massage, back light becomes white.



4. In ON status, press this key to enter Heat level one, level two, level three and heat off in turn.



5. In ON status, press this key successively to enter Gravity Free, Leisure, Sleep and Reset Mode in turn.



6. In ON status, keep pressing this key to extend the footrest, release it to stop.



7. In ON status, keep pressing this key to retract the footrest, release it to stop.



8. In ON status, keep pressing this key to raise the legrest, release it to stop.



9. In ON status, keep pressing this key to lower the legrest, release it to stop.



10. In ON status, keep pressing this key to raise the backrest and lower the legrest, release it to stop.



11. In ON status, keep pressing this key to lower the backrest and raise the legrest, release it to stop.

Massage operation

Tablet remote control operation

Tablet Remote Control



LCD Touch Screen

1. Tablet is ON by default after the chair is powering on and will display the ON interface. If no operation over 2mins, the tablet will go dark.

Theme message interface

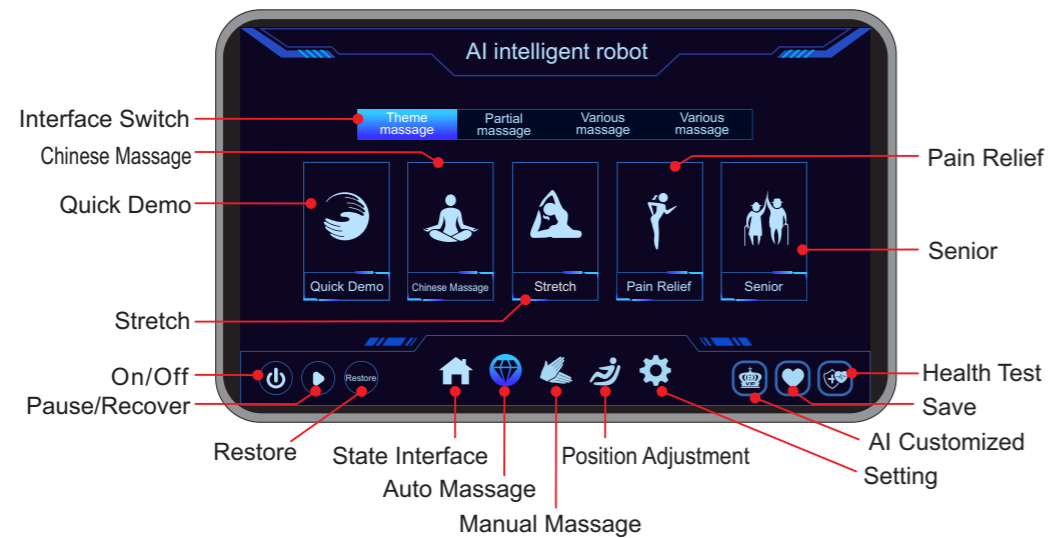

Quick Demo
In the ON status, press this icon to enter Quick Demo mode, default working time for this auto program is 8 minutes.

Chinese Massage
In the ON status, press this icon to enter Chinese Massage mode, default working time for this auto program is 20 minutes.

Tablet remote control operation

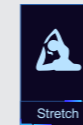

In the ON status, press this icon to enter stretch mode, default working time for this auto program is 20 minutes.

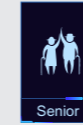

In the ON status, press this icon to enter Senior mode, default working time for this auto program is 20 minutes.

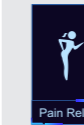

In the ON status, press this icon to enter the Pain Relief mode, default working time for this auto program is 20 minutes.



On/Off key, click it, it will light up, the chair will start working after powering on.



Restore key, after choosing this key, the chair won't get back to the upright position after message is over. And the chair will reset normally without choosing this key.



Auto message key, click it to enter auto message interface.



Position adjustment key, click it to enter position adjustment interface.



AI customized key, click it to enter customized setting interface.



Health test key, click it to enter health test interface.



Pause/Recover key, click it to stop all message functions, click it again to continue all message functions.



State interface key, click it to enter state interface.



Manual message key, click it to enter manual message interface.



Setting key, click it to enter setting interface.



Save to my favorite key, click it to enter my favorite interface to save or delete favorites.

Massage Interface

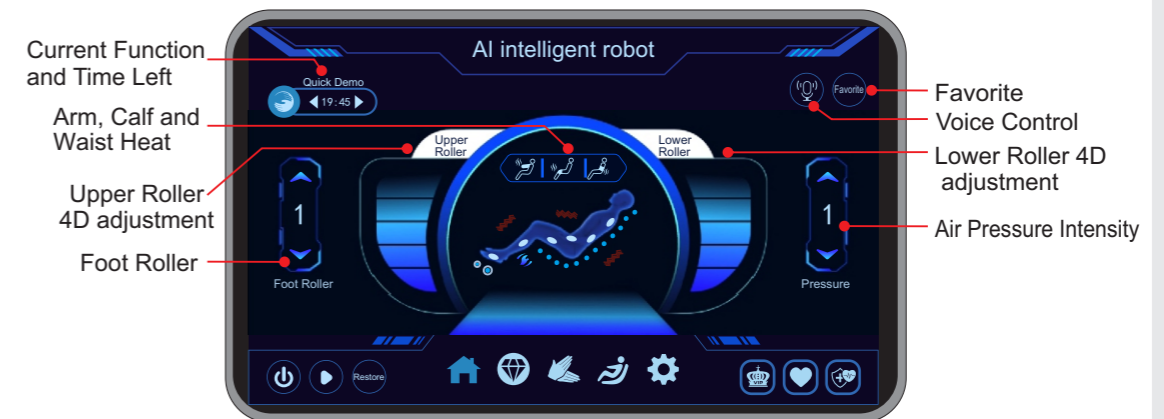

Voice control key, click it to enter voice command interface.

Favorite key, click it to save the current working message to my favorite and it will be kept well even if out of electricity. If saved more than 8 modes, it will remind you to delete some before saving again.



Foot roller key, click it to turn on/off foot roller function.



Click up or down arrow to increase or decrease air strength.



Press it to adjust upper roller 4D+ or 4D-



Press it to adjust lower roller 4D+ or 4D-



Arm, calf and waist heat key, click it to turn on/off and adjust the levels of heat function.



The body image can display the heat, massage rollers position, foot roller and calf rubbing state.

Tablet remote control operation

Partial massage interfac

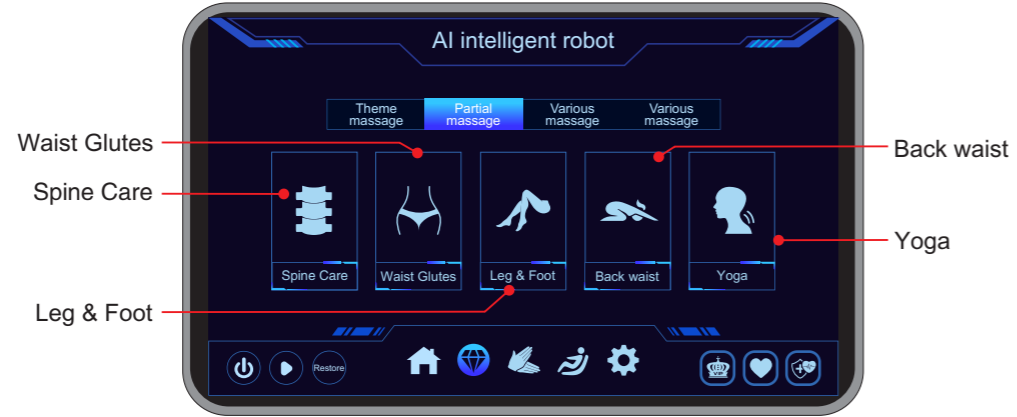

Waist Glutes

Spine Care

Leg & Foot

Back waist

Yoga

Spine Care
In ON status, click and light up the icon to start Spine Care Massage.

Leg & Foot
In ON status, click and light up the icon to start Leg and Foot Massage.

Yoga
In ON status, click and light up the icon to start Yoga Massage.

Waist Glutes
In ON status, click and light up the icon to start Waist Glutes Massage.

Back waist
In ON status, click and light up the icon to start Back and Waist Massage.

Various massage nterfac

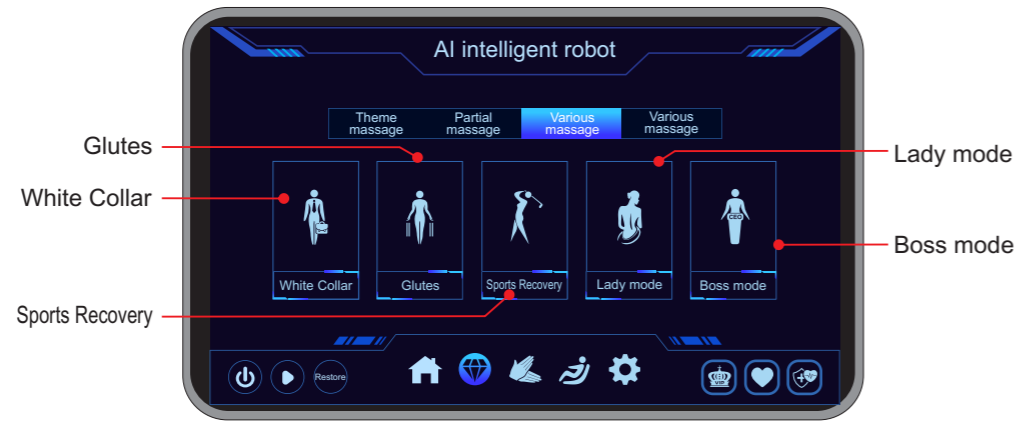

Glutes

White Collar

Sports Recovery

Lady mode

Boss mode

Massage operation

Tablet remote control operation

White Collar
In ON status, click and light up the icon to start White Collar Massage.

Sports Recovery
In ON status, click and light up the icon to start Sports Recovery Massage.

Boss mode
In ON status, click and light up the icon to start Boss mode Massage.

Glutes
In ON status, click and light up the icon to start Glutes Massage.

Lady mode
In ON status, click and light up the icon to start Lady mode Massage.

Various massage interfac

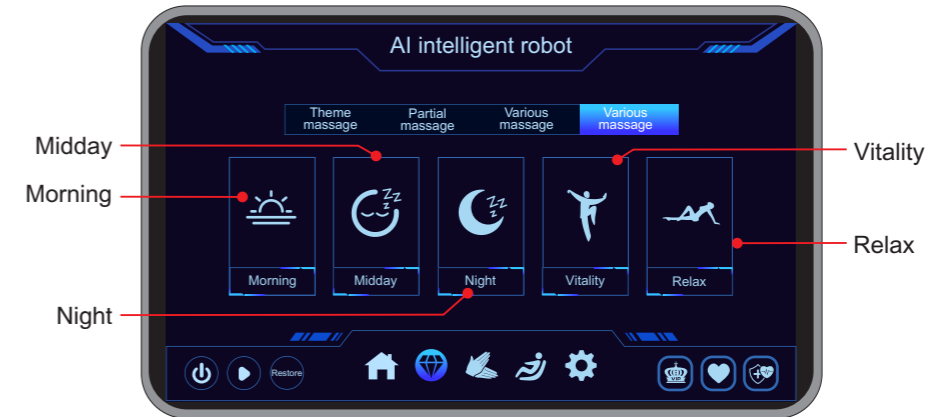

Midday

Morning

Night

Vitality

Relax

Morning
In ON status, click and light up the icon to start Morning Massage.

Night
In ON status, click and light up the icon to start Night Massage.

Relax
In ON status, click and light up the icon to start Relax Massage.

Midday
In ON status, click and light up the icon to start Midday Massage.

Vitality
In ON status, click and light up the icon to start Vitality Massage.

Massage operation

Tablet remote control operation

Position Adjustment Interface

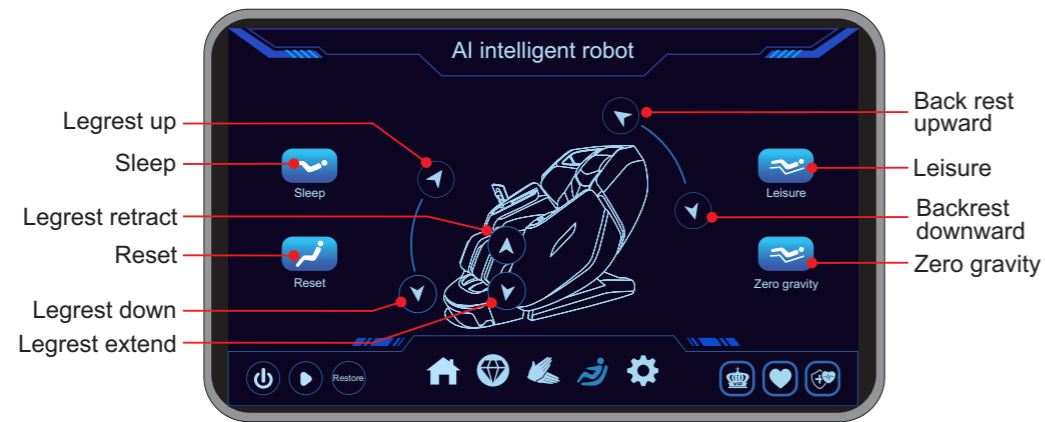

Massage operation

Voice command interface

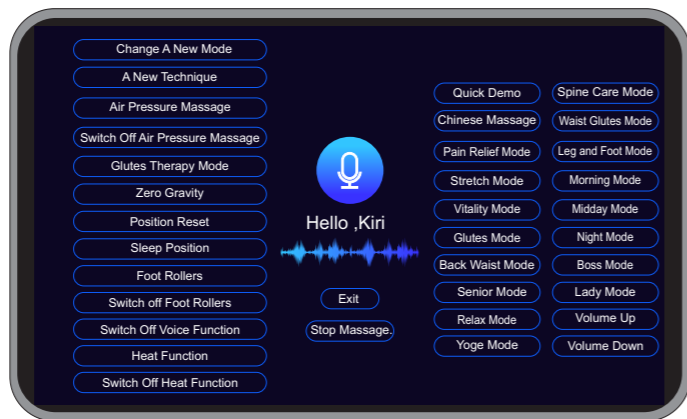

Tablet remote control operation

Manual Massage Interface

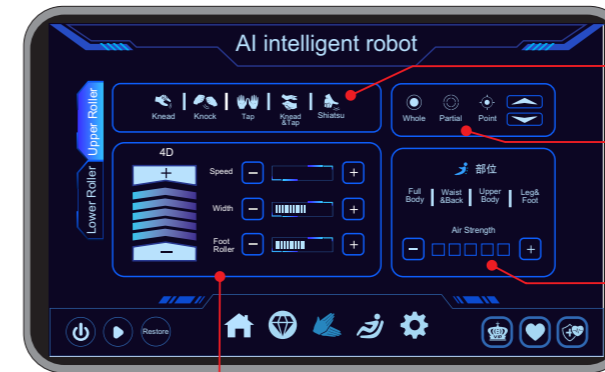

Massage Technique: Kneading, Knock, Tapping, Knead+Tap, Shiatsu.

Position: Whole, Partial, Point, Upward, Downward.

Air Massage: Full Body, Waist& Back, Arm& Shoulder, Leg& Foot.

4D Adjustment Menu. Massage speed, width and foot roller adjustment.

Massage operation

Customized Interface

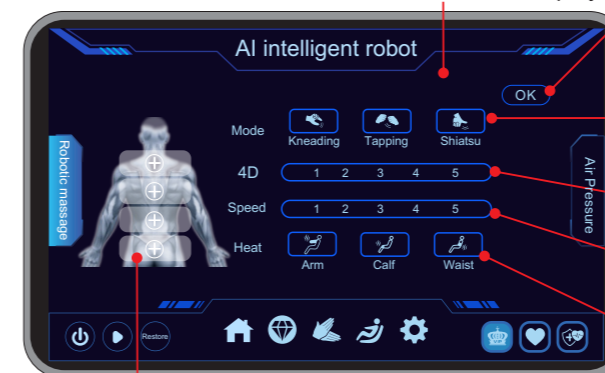

Mechanical Massage Interface Display

After completing the settings, click the "OK" button to run the customized program.

Mode and Technique Selection Menu: Emphasizing Kneading, Emphasizing Tapping, and Emphasizing Shiatsu are the three techniques.

The 4D intensity setting uses a slider with a default of 3 levels.

The massage mechanism speed setting uses a slider with a default of 3 levels.

Heat Setting on arm, leg and waist.

By AI customized position key, u could choose four postion including Neck & Shoulder, Back, Waist and Hips with corresponding display. If enter AI customized from other interface, the original position and state will keep no change.

Tablet remote control operation

Customized Interface

Air Pressure Massage Interface Display

After completing the settings, click the "OK" button to run the customized program.

Airbag position key, can adjust the level after selected.

Whole Air Pressure Intensity Setting Slider, defaulting to level 3.

Upper Body Air Pressure Intensity Setting Slider, defaulting to level 3.

Waist & Hips Air Pressure Intensity Setting Slider, defaulting to level 3.

Leg & Feet Air Pressure Intensity Setting Slider, defaulting to level 3.

Calf Rubbing Speed Setting Slider

Foot Roller Setting Slider

Full Body Airbags Display Status, illuminated means selected.

My Favorite Interface

It can save eight programs at most. Click the program and long press to remove. Manual mode can't be saved. The saved programs will be kept well even if out of electricity.

Settings Interface

Language setting, Chinese and English is available.

Additional functions, allowing for on/off settings for voice control, Anion, and aromatherapy; network configuration for voice modules, allowing for network operation according to voice prompts.

System update, check for update is currently a reserved function.

Massage operation

Tablet remote control operation

Health Test Interface

Test Note: Please kindly adjust to the most comfortable position, put index finger on the sensor of right armrest. Be relax and adjust breath, click start testing, enter the test progress interface.

Start testing. Click it to do health test.

Blood oxygen, microcirculation, heart rate and fatigue level data are only for reference.

Health Test Progress Interface

Health Test Progress Bar

Health Test Result Interface

Blood oxygen, microcirculation, heart rate and fatigue level data will come out after detection.

Click it to test again.

Body scanning interface

Body shape detecting

- Please adjust your sitting position.
- Lean your back closely to the backrest of the chair.
- Put your head to the pillow, adjust to the deepest area of the chair.

Detecting, please wait....

Body scanning finished, enter into manual shoulder height position adjustment interface.

Manual shoulder height adjust

Shoulder height adjustment

Shoulder height detecting automatically is completed, slightly adjust the height per your actual need

Massage operation

Voice control use method

The use of smart voice control (has voice control function)

In the standby mode, press the power button on the tablet handheld controller or the convenient handheld controller to enter the powered-on state. At this time, the voice recognition system enters the waiting state.

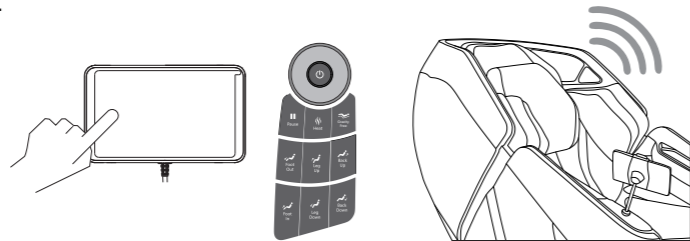

- When using the voice recognition function, please say "Hello, Kiri" before the system can recognize subsequent voice commands.
When the massage chair recognizes the command, there will be corresponding speaker voice feedback, it means the command recognition is successful.
- Please using standard Mandarin to say the following voice command, if it is not recognized, please pause for 2 seconds, turn up the volume and say it again. Male and female voice switch: say "Hello, Kiri ", switch to boys (girls); when hearing "power on for you to switch to male voice (girls)", and disconnect the massage chair power on again, voice switch to male voice (female voice).

● Voice command entry:

Voice control
Hello,KIRI
Hello,KIRI , Stop massage
Hello,KIRI , Change a new mode
Hello,KIRI , Quick demo
Hello,KIRI , Chinese massage
Hello,KIRI , Pain Relief mode
Hello,KIRI , Stretch mode
Hello,KIRI , Neck Shoulder mode
Hello,KIRI , Glutes mode
Hello,KIRI , Back waist mode
Hello,KIRI , Sports recovery mode
Hello,KIRI , Senior Mode
Hello,KIRI , Relax mode
Hello,KIRI , Vitality mode
Hello,KIRI , Yoga mode
Hello,KIRI , Spine Care mode

Voice control use method

● Voice command entry:

Voice control
Hello,KIRI , Morning mode
Hello,KIRI , Midday mode
Hello,KIRI , Night mode
Hello,KIRI , Boss mode
Hello,KIRI , Lady mode
Hello,KIRI , Waist Glutes mode
Hello,KIRI , Leg and Foot mode
Hello,KIRI , A new technique
Hello,KIRI , Full body massage
Hello,KIRI , Partial massage
Hello,KIRI , Point massage
Hello,KIRI , Rollers up
Hello,KIRI , Rollers down
Hello,KIRI , Air pressure massage
Hello,KIRI , Switch off air pressure massage
Hello,KIRI , Backrest Up
Hello,KIRI , Backrest Down
Hello,KIRI , Legrest Up
Hello,KIRI , Legrest Down
Hello,KIRI , Leg extension
Hello,KIRI , Leg retraction
Hello,KIRI , Speed up
Hello,KIRI , Slow down
Hello,KIRI , 4D Plus
Hello,KIRI , 4D Minus
Hello,KIRI , Strong air
Hello,KIRI , Weak air
Hello,KIRI , Zero gravity
Hello,KIRI , Position reset
Hello,KIRI , Foot rollers
Hello,KIRI , Switch off foot rollers
Hello,KIRI , Heat function

Voice control use method

- Voice command entry:

Voice control
Hello,KIRI , Switch off heat function
Hello,KIRI , Anion function
Hello,KIRI , Switch off anion function
Hello,KIRI , Pause massage
Hello,KIRI , Continue massage
Hello,KIRI , Switch off voice function

Caution: 1.This function is an intelligence recognizing, support expansible command with key words.
2. This function will be updated automatically, may be revised without reminding.

Restoration of the massage chair

- 1 Confirm whether there are people, pets or other items in the movement range of this chair's backrest or leg-rest.

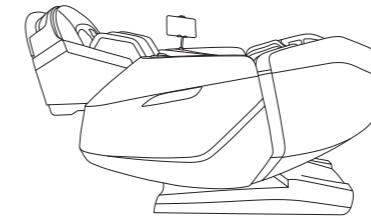

- 2 Use a manual controller to slowly restore the backrest and legs to their original position. (Or to directly press the "switch" button off can also make the backrest and leg-rest slowly return to their original position.

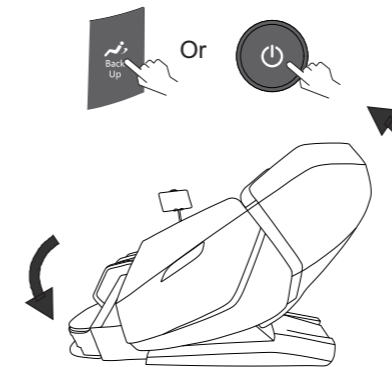

- 3 After being stored, put the hand controller back on the tablet bracket of right armrest.

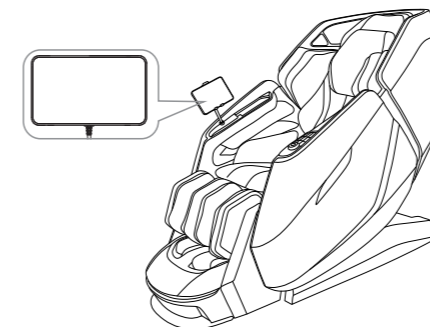

- 5 Turn off the power switch.

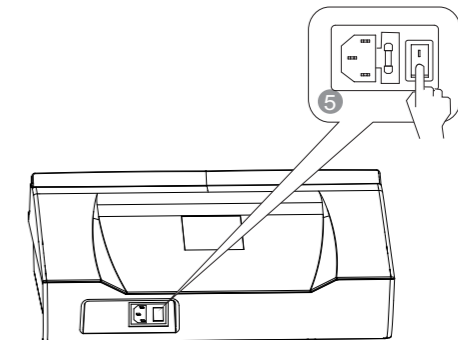

- 6 Unplug the power plug from the power socket. (Attention: hold the right plug position)

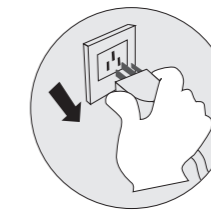

- 7 Do proper tidies and cleaning.

! Attention

- After the massage, press the "on/off" button to turn off all the massage movements and wait for the massage rollers to be collected and put in place.
After use, make sure the power supply is disconnected to avoid accidental injury to children or other pets.
- After use, turn off the power switch, pull out the power cord plug, Environmental protection and energy saving.
Avoid pulling the power plug by pulling the power cord alone.
Avoid damage caused by moisture, dust and degradation of insulation.

Synthetic leather

● General cleaning

Clean with tidy, soft and dry cloth slightly.



(Chemical or medical cleaning products are forbidden)



Forbidden

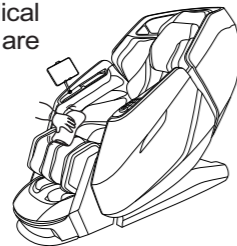

● If leather is dirty

- 1 Dip soft cloth into 3-5% neutral detergent solution, squeeze it then clean the stain on the surface gently.
- 2 Wash cloth, squeeze it and wipe with detergent.



- 3 Clean it softly with dry cloth.
- 4 Allow to dry (air blower is prohibited)

Cloth material

- 1 Dip cloth into weak neutral detergent, squeeze it and clean the material surface.

- (Diluent, gas, alcohol are prohibited)
Brush the dirty parts with weak neutral detergent. (avoid excessive brushing)

- 2 Excessive cleaning may cause damage to cloth material.
- 3 Wipe with water-dipped but squeezed cloth.
- 4 Allow to dry.



Plastic parts

- 1 Dip cloth into neutral detergent, squeeze it and clean.
- 2 Wipe with water-dipped but squeezed cloth.
- 3 Allow to dry.



Clean the controller

- 1 Wipe with soft cloth after squeezing.
- 2 Allow to dry.
Propellant, diluent or alcohol are prohibited.



Forbidden

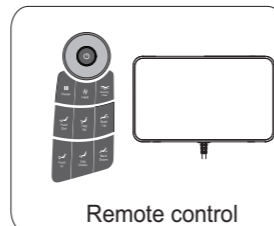

Remote control



About cleaning

- Before cleaning, unplug the electricity, don't touch plug with wet hands.
- Make sure hands are dry when plugging to the socket.
- If failed to follow the mentioned instruction, user may get electric shock or burned.

FAQ and Troubleshooting

Trouble	Possible reason	Troubleshooting
The massage chair can't work after power is on.	Check if the control is on or not.	Open control switch
	Not choose massage function	Choose massage function
	Check whether the plug and socket in poor contact.	Make sure plug and socket are connected.
	Wire or plug has damaged.	Please ask manufacturer or appointed or authorized maintenance man for checking and replacement.
	The fuse burned out.	Replace fuse of same specification.
There is beep sound inside the massager while working.	Something wrong with inner circuit	Please ask appointed or authorized maintenance man for checking and repairing.
	It is sound of air pump, motor and mechanical parts.	Normal sound, no need to pay attention to it.
Different height of the left roller and right roller.	Massage rollers work on shifts.	Normal, no need to pay attention to it.
Sound suddenly becomes much louder while working.	Check if it is due to long time working.	Turn off the power to have the massager rest for over half an hour before next turn working.
	Inner parts fretted away due to long time work. It's normal	Please ask appointed or authorized maintenance man for checking and repairing.
Massage function suddenly stops while working.	Suddenly power-down	Connect the electricity power again
	Setting time is up.	Turn off the power to have the massager rest for over half an hour before next turn working.
Neither the backrest nor the legrest can be lay down.	Check if there are any obstacles; the chair overloads; for the sake of safety, sometimes the massage machine may automatically stop working.	Remove the obstacles; turn off the power to have the massager rest for over half an hour before next turn working.
	There is heavy things on power box.	
The chair can't return to its original position.	Excessive operation; setting time is up.	Please ask manufacturer or appointed or authorized maintenance man for checking and replacement.
Electric wire or plug give out heat	It may work overload	Turn off the power to have the massager rest for over half an hour before next round working.
	Other abnormal case	Stop using, and ask appointed maintenance man for help.



Note: If the troubles are not caused by above reasons, please turn off the power switch and cut off the power, then contact the manufacturer or service agent to repair your chair.

Technical data

Name	Massage Chair	Power	300W
Model	RK7603E	NW/GW	Main body :118.5/141.2kg Armrest :15/19.8 kg
Input voltage	220V~ 50/60Hz		
Safety design	Class I	Packing size	Main body:1490×825×1030 mm Armrest : 985×425×750 mm (L×W×H)