



Orion V2 Massage Chair

Operation Instructions

info@nourest.com | www.nourest.com
+971 52 744 3151

SAVE THESE INSTRUCTIONS



Thanks for purchasing this product. Please read this manual instruction carefully in order to know how to use this product correctly before operation. Please pay more attention to some important safety warning and keep this manual book properly for future use.

Note: Our company reserves the right to change and explain the design of the product. If there is some difference between the product function in market circulation and the description in the manual, it is a normal update of the product, and our company will not inform you otherwise. The specific product function and color shall prevail in kind.

CONTENTS

Before Use

Safety Precautions -----	02-04
Installation Parts -----	05-06
Place Massage Chair -----	07
Before Use -----	08
Product Structure -----	09-11

Usage Method

Operation Instructions -----	12-14
------------------------------	-------

Maintain



Cleaning and Maintenance -----	15
--------------------------------	----

Important

Troubleshooting -----	16
Product Specifications -----	17

Safety Precautions must be observed

- Please read all relevant instructions carefully before use.
- The notes marked here will help you to use the product safely and correctly.
- In order to clearly indicate the extent of harm and damage, precautions are divided into **"Warning"** and **"Caution"** that may be caused by incorrect use. Both of them are important for safety and must be followed.

 Warning	Indicates that serious injury or death may result from improper use.
 Caution	Indicates that misuse may cause minor injury or property damage.

- Please pay attention to the symbol before each safety item.

 Forbidden	Absolute prohibition
--	----------------------

The following populations should not use this product

 Forbidden	<ul style="list-style-type: none"> ■ The device is not intended for use by persons (including children) with physical disabilities, sensory or neurological impairments or who lack experience and common sense, unless they are supervised and instructed in the use of the device by those responsible for their safety. Children must be supervised to ensure they do not play with instruments. ■ Patients with osteoporosis. ■ Patients with heart disease or wearing electronic medical devices such as a pacemaker. ■ People who have a fever. ■ Pregnant women or women on their menstrual period. ■ Patients who are injured or have a skin disease. ■ When unsupervised, any children are under the age of 14 and those unconscious are not allowed to use this product. ■ People who are told by their physicians to have rest or who feel unwell. ■ People whose bodies are wet are forbidden to use this product. ■ This product has a hot surface. Persons insensitive to heat must pay attention when using this product. ■ If the supply cord is damaged, to avoid danger, it must be replaced by a professional from the manufacturer, its maintenance department or similar department
---	---

Safety Precautions must be observed

Important safety warnings	
 Warnings	<ul style="list-style-type: none"> ■ Do not allow children to touch any movable part of this product. ■ Use the well-grounded power supply unit suitable for this product. ■ Pull out the plug after use or before cleaning to avoid any physical injury or damage to the product. ■ Operate this product as instructed in this manual. ■ Do not use any parts or accessories which are not recommended. ■ Do not use this product outdoors. ■ Please read the Operation Instructions carefully before operation. ■ Never use this product for any other purpose not listed herein. ■ 20 minutes of usage each time is recommended. ■ Do not use this product if the cover or leather is broken or damaged. ■ Do not drop anything into this product. ■ Never fall asleep while using this product. ■ Do not use this product if you are drunk or feel unwell. ■ Do not use this product within one hour after a meal. ■ Do not use this product with excessive force to avoid any injury.

Safety precautions	
 Caution	<ul style="list-style-type: none"> ■ Check whether voltage is consistent with the specification of this product. ■ Never insert or pull out the plug with a wet hand. ■ Do not let water flow into this product to avoid electric shock or cause damage to this product. ■ Do not pull the power cord when plugging or unplugging it. Rough handling is forbidden. ■ Do not damage the wire or modify the circuit of this product. ■ Do not clean live parts of this product with a wet cloth such as a power switch and plug. ■ Be away from this product in case of power failure to avoid any injury if power is restored suddenly. ■ Stop using this product at once while it works abnormal, and consult your local supplier. ■ Stop using this product if you feel unwell, and consult your health care practitioner.

Storage conditions	
 Caution	<ul style="list-style-type: none"> ■ Storage room temperature: 5 °C to 40 °C. ■ Relative humidity (RH) between 20% and 80%; free of corrosive gases, and a well-ventilated room.

Safety Precautions must be observed

Product service and maintenance	
 Caution	<ul style="list-style-type: none"> ■ This product should be maintained by the service center designated by the manufacturer only. No user should disassemble or maintain it without permission. ■ Do not forget to turn off the main power switch after usage. ■ Do not use this product if the power socket becomes loose. ■ If this product will be left unused for a long period of time, it is necessary to roll up the power cord of this product and store this product in a dry and dust-free environment. ■ Do not store this product at a high temperature or near open flame. Avoid prolonged exposure to direct sunshine. ■ Please clean this product with dry cloth. Never use thinner, benzene or alcohol. ■ The mechanical components of this product are specially designed and manufactured, so no special maintenance is needed. ■ Do not use a sharp object to stab at this product. ■ Do not roll or pull this product on any uneven ground. Instead, it should be lifted before moving. ■ Please use this product intermittently. Do not keep it working continuously for a long period of time.

Operating environment	
 Caution	<ul style="list-style-type: none"> ■ Do not use this product in a very moist environment such as the bathroom. ■ Stop using this product immediately when the ambient temperature changes sharply. ■ Do not use this product in any heavily-dusty or caustic environment. ■ Do not use this product in a small space or a place without good ventilation.

Solutions to ordinary malfunctions	
 Caution	<ul style="list-style-type: none"> ■ If the motor sounds during operation of this product, this is the normal operation sound. ■ If the controller cannot work normally, check whether the plug and the power socket are connected reliably, and whether the power switch is turned on. ■ If the rated working time is over, this product will automatically activate the power-off button; If this product keeps operating for a long period of time, the temperature protector will stop this product automatically. The product can be used again after half an hour.

Installation parts

1、Open the box and take out accessories as below.

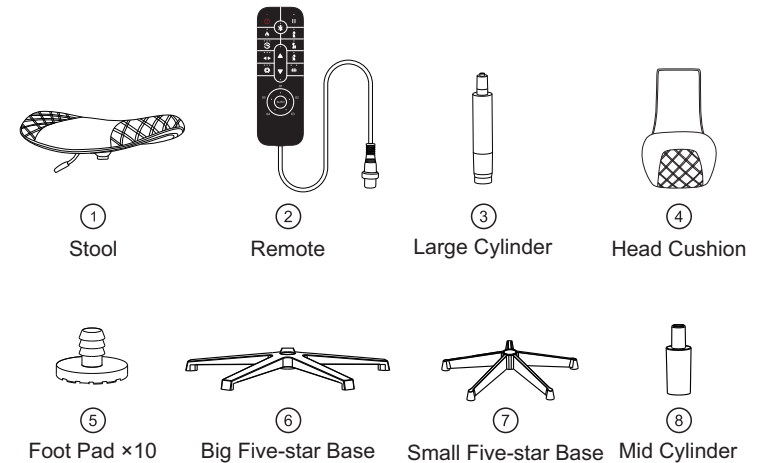

2、put the foot pad into the two five-star base hole.

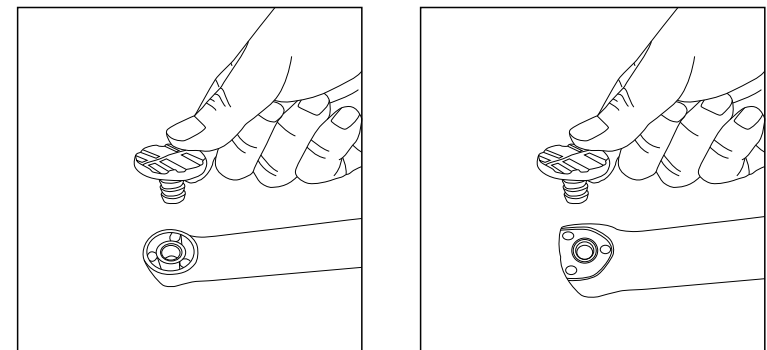

Installation parts

3、insert the mid pole to the big five star base, another side insert the chair as below.



4、insert the gas pole to the small five-star base hole, then put the stool into the other end.

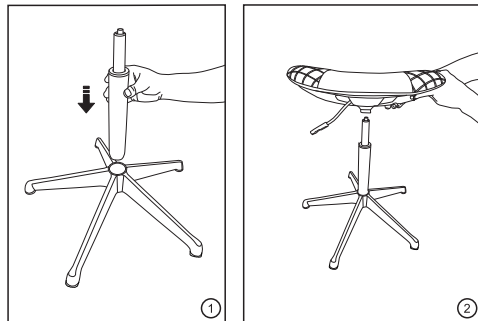

5、let the head cushion go through the strip, and adjust to the suitable height.

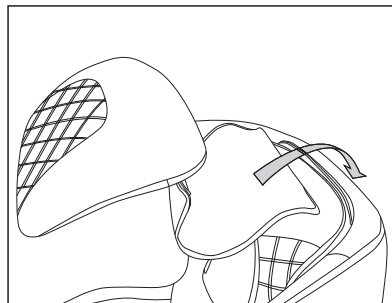

Place massage chair

Installation placement

Make sure there is enough space for the massage chair can be tilted at least 30 cm.



Do not expose the massage chair directly to high temperature environment due to sunlight (such as: in front of heating equipment), and place it to where can avoid high temperature and direct sunlight. It is recommended to lay a soft cushion for long-term use in a designated location. When laying the cushion, the size of the cushion should be enough to cover. Keep the range where the machine touches the floor and the range where your feet touch the floor.



Product lift instruction

Require team work to lift and move the chair to avoid injury.



1. Please lift the massage chair to move it on vulnerable ground such as wooden floor.
2. When moving on a similar wooden floor, it is recommended to lift it. Avoid damage to the casters. When the floor is lifted and moved to the designated position, be careful to keep your hands out of the way to avoid injury, and be careful of your feet being crushed. Do not let go of the unit until the unit is completely flat, the floor may be damaged, therefore, it is recommended to place mats, etc. on the floor.

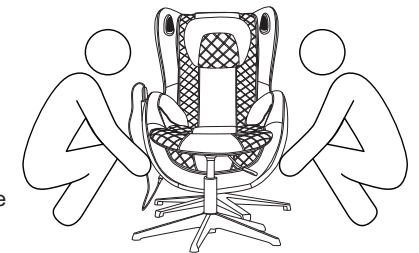

Before use

Check around

Make sure that there are no people, pets and other objects around the unit.



Turn on the power



Diagram of plug in



Diagram of the switch position of power supply



- Please check whether the power cord and power plug are damaged before use.
- Please supply power to this product in accordance with the working power requirements of this product's calibration.
- It is strictly forbidden to use a power supply other than the nominal power supply of this product.
- It is strictly forbidden to connect various power conversion devices to supply power to this product without authorization.

Product Structure

Parts description

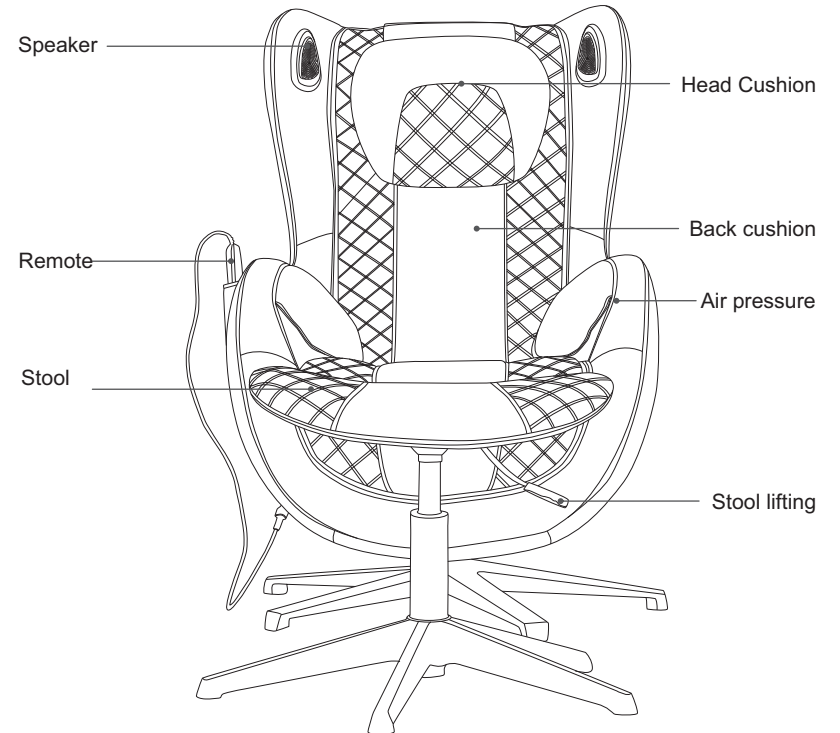

Product Structure

I .Introduction of the remote controller

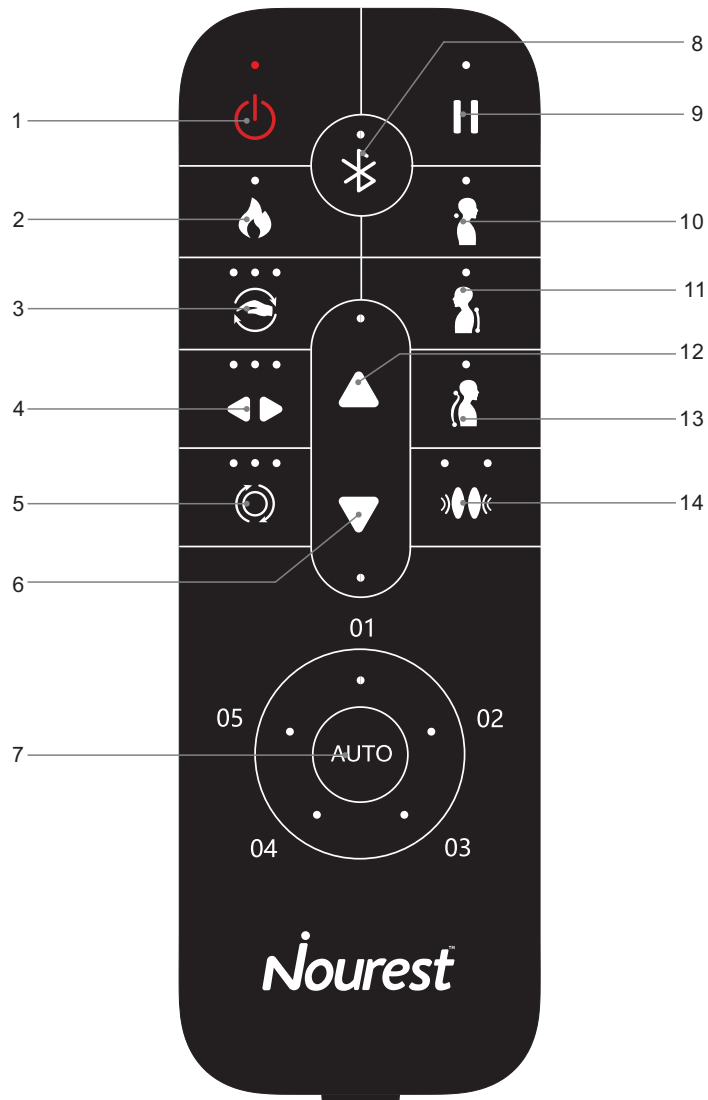

Product Structure

1、 On/Off key:

· Turn on or off the massage chair.

2、 Heat treatment key:

· click the key to turn on/off heat treatment function .

3、 Technique:

· For details, please refer to page 13 of this manual.

4、 Width adjustment:

· Three level of width can adjust.

5、 Speed adjustment:

· there level: slow medium , fast.

6、 massage roller lower adjustment, shoulder position lower adjustment:

· manual adjustment.

7、 auto key:

· For details, please refer to page 12 of this manual.

8、 bluetooth key:

· on/off bluetooth key(Power-off preservation).

9、 Pause key:

· pause /resume the work.

10、 Times Key:

· For details, please refer to page 13 of this manual.

11、 area massage key:

· For details, please refer to page 13 of this manual.

12、 massage roller upper adjustment, shoulder position upper adjustment:

· manual adjustment.

13、 full body massage:

· For details, please refer to page 13 of this manual.

14、 Air pressure key:

· Air intensity adjust , two level.

Operation Instructions

II. Start massage

- ① press "⏻" to start massage, Enter the body type detection state(5 indicators flashing back and forth).
- ② After the body detection, enter the shoulder adjustment state(the shoulder adjustment up/down key flashes synchronously).
- ③ After the shoulder position is confirmed, it will enter the comfortable massage by default. After starting the massage, you can also choose other massage modes for massage.

A). Automatic massage:

name	Button	massage description	Description	Display
Automatic massage		Comfort	The most comfortable massage experience.	● 01
		Relax	The most relaxing massage experience.	● 02
		Shoulder & neck	Focus on shoulder and neck massage	● 03
		Back&waist	Focus on back and waist massage	● 04
		Full body massage	Full body massage point massage	● 05
Note: This key can be used as a function key to skip body detection or shoulder adjustment				

B). shoulder adjustment:

Function	Button	Description
Shoulder upper		adjust the shoulder position by manual
Shoulder lower		
Note: Effective only under shoulder adjustment or automatic massage.		

C). Other functions:

Function	Button	Description
Power key		When the massage is on, the indicator light on; when it is paused/reset, it is blinking; when it is in standby state, the lights off.
Pause key		For details, please refer to page 11 of this manual.
Bluetooth		For details, please refer to page 11 of this manual.

Operation Instructions

D). Manual massage

Technique:

Name	Button	massage description	massage roll adjustment	Display
Technique		Knead	speed	●○○
		Tap	speed, width	○○●
		Knead pat	speed	○○●
		Shiatsu	speed, width	●●○
		Knock	speed, width	○○●

Speed/ width adjustment:



Function	Button	Description	Display
speed		3 speed adjustment	●○○ ○●○ ○○● slow medium fast
width adjustment		The width of the third gear can be adjusted.	●○○ ○●○ ○○● narrow medium wider

Position, back stretch adjustment:

Function	Button	Description	
Back stretch		Fixed position and spot massage.	
		Small area local round trip massage(partial).	
		A round trip massage(full back).	
position adjustment		Massage position adjustment (in fixed point and local mode, massage position can be adjusted).	Manipulator uplink
			Manipulator descending

Operation Instructions

E). Other massage functions

Function	Button	Description	Display
Pressure		2 air intensity adjustable	
Heat		Press this button to turn on or turn off the back graphene heating, and it will warm after 3 minutes.	

IV. Operation Instructions for Bluetooth Speaker Play

1. The smart device will search for the corresponding Bluetooth model (e.g. IMCM-XXXX), Click the "Match" button, if you are asked whether to match with the device, you just select "Match" to complete matching.
2. Turn on "Music Player" in the smart device and select the song to play.

Cleaning and Maintenance

Clean PU leather and plastic parts

Wipe the leather with a soft, dry cloth.

■ Do not use chemicals such as thinner, gasoline, alcohol, etc. to clean the unit.

■ When using commercially available leather care products (rags), please follow the instructions for use.

■ If the PU leather is particularly dirty, wipe it by the following methods.

- ① Immerse a soft cloth in water or hot water containing 3% to 5% neutral detergent, then wring it out thoroughly.
- ② Use the above soft cloth to wipe the leather surface.
- ③ Wipe off the cleaning solution with a cloth soaked in clean water and thoroughly wrung out.
- ④ Wipe with a wrung soft cloth.
- ⑤ Let it air dry naturally.

■ When it is difficult to remove stains, please immerse commercially available melamine foam in neutral detergent, and then wipe the machine with it.

■ Do not use a hair dryer to dry the surface.

■ As the color of the fabric will stain the surface of the PU leather, be careful when wiping the chair with denim and colored fabrics.

■ Do not keep these parts in contact with plastic for a long time, as this will cause discoloration.

■ PU leather may be discolored, so when using hair dye, please cover the touched part with a towel.



Troubleshooting

Fault	When the calf mechanism or the backrest reaches a certain position, press the corresponding adjustment button and it will no longer change, and a continuous "beep, beep" sound will be emitted.
Solution	Due to product structure design and ergonomic requirements, this product has a limited protection design for the limit state of attitude adjustment. At the same time, a reminder sound will sound when the limit is reached.
Fault	The function does not work or some functions do not work after the machine is turned on.
Solution	After the machine is turned on by pressing the switch key, it is necessary to manually select an automatic massage program or other working state. If it is not operated, the machine will automatically shut down after 20 minutes. If the manual operation mode is selected, the functions that are not selected may be disabled, and the working mode needs to be manually set in the manual mode.
Fault	The machine makes a leather rubbing sound when adjusting its posture.
Solution	This product adopts high-grade anti-corrosion leather that meets environmental protection requirements. Due to the inherent characteristics of leather materials, there will be a normal slight noise when rubbing at the relative movement, which is a normal phenomenon. Note: If you hear fabric or leather tearing sound when the machine is running, please stop using it immediately and seek professional maintenance.
Fault	The massage wheel did not reach the shoulders or neck.
Solution	If the head does not touch the head cushion or the back does not touch the backrest, the shoulder position may be lower than the actual position during the body shape detection process. Sit in the deepest position of the seat, rest your head on the headrest, and start over from the beginning.
Fault	The unit is damaged. The power cord or power plug is abnormally hot.
Solution	To prevent accidents, be sure to contact an authorized service center.

Please feel free to contact the designated service personnel for any questions or doubts about this product.

Product Specifications

Model: Orion V2
 Name: Massage Chair
 Rated voltage: 220-240V~ 50Hz
 Rated power: 55W
 Rated time: 20min
 Safety structure: Class I

Material description: PVC, PA, steel parts, electric and electron components

MATERIAL	PU	LEATHER	CLOTH	WOOD